

ESB Asset  
Alterations





# BUSCONNECTS DUBLIN CORE BUS CORRIDORS INFRASTRUCTURE WORKS

## KIMMAGE TO CITY CENTRE CORE BUS CORRIDOR SCHEME

ESB ASSET ALTERATIONS. RECORDS AND PROPOSED WORKS.	
DRAWING SERIES NUMBER(S)	DRAWING SERIES DESCRIPTION
BCIDD-ROT-UTL_IX-0011_XX_00-DR-CU-0003	KIMMAGE TO CITY CENTRE CORE BUS CORRIDOR SCHEME. ESB ASSET ALTERATIONS. COVER SHEET
BCIDD-ROT-UTL_KP-0011_XX_00-DR-CU-0003	KIMMAGE TO CITY CENTRE CORE BUS CORRIDOR SCHEME. ESB ASSET ALTERATIONS. KEY PLAN
BCIDD-ROT-UTL_UE-0011_XX_00-DR-CU-0001 to 0014	KIMMAGE TO CITY CENTRE CORE BUS CORRIDOR SCHEME. ESB ASSET ALTERATIONS. DRAWINGS.

\\wddubp1u20191917117117-02\_WIP08 MODELS01 CAD01 DWG03 STG 3 - STATUTORY PROCESS (M)01 PLANNING11 KIMMAGECOVER SHEETS/BCIDD-ROT-UTL\_IX-0011\_XX\_00-DR-CU-0003.dwg

**Disclaimer**

a. © National Transport Authority (NTA) 2022. This drawing is confidential and the copyright in it is owned by NTA. This drawing must not be either loaned, copied or otherwise reproduced in whole or in part or used for any purpose without the prior permission of NTA.

b. This drawing is to be used for the design element identified in the titleblock. Other information shown is to be considered indicative only. The drawing is to be read in conjunction with all other relevant design drawings.

c. O.S. data used for plans are printed under © Ordnance Survey Ireland Government of Ireland. All rights reserved. Licence Number 2022/OSI\_NMA\_180 National Transport Authority. All elevations are in metres and relate to OSI Geoid Model (OSGM15) Mean Head. All Co-ordinates are in Irish Transverse Mercator Grid (ITM) as defined by OSI active local GPS station.

d. Information concerning the position of apparatus shown on this drawing is based on drawings supplied by the utility owners and/or the utility works contractor, whilst every care has been taken in the preparation of this drawing, positions should be taken as approximate and are intended for general guidance only and no representation is made by the NTA as to the accuracy, completeness, sufficiency or otherwise of this drawing and the position of the apparatus. The information contained herein does not purport to be comprehensive or final as the apparatus is subject to being altered and/or superceded. Recipients should not rely on this information. Any liabilities are hereby expressly disclaimed.

e. The information contained herein has been provided by the NTA but does not purport to be comprehensive or final. Recipients should not rely on the information. Neither the NTA nor any of its directors, officers, employees, agents, stakeholders or advisers make any representation or warranty as to, or accept any liability or responsibility in relation to, the adequacy, accuracy, reasonableness or completeness of the information provided as part of this document or any matter on which the information is based (including but not limited to loss or damage arising as a result of reliance by recipients on the information or any part of it). Any liabilities are hereby expressly disclaimed.



Rev	Date	Dwn	Chk'd	App'd	Description
M01	FEB 2023	CG	SMG	SMG	ISSUE FOR PHASE 4: PLANNING

Client <b>NTA</b> Údarás Náisiúnta Iompair National Transport Authority		Engineering Designer <b>ROD</b> TYP SA RUGHAN & O'DONOVAN		
Date FEB 2023	Scale NTS @ A1 NTS @ A3	Drawn CG	Checked SMG	Approved SMG
Programme Code BCIDD	Originator Code ROT	QMS Code		

Programme Title <b>BUSCONNECTS DUBLIN CORE BUS CORRIDORS INFRASTRUCTURE WORKS</b>			
Drawing Title KIMMAGE TO CITY CENTRE CORE BUS CORRIDOR SCHEME ESB ASSET ALTERATIONS COVER SHEET			
Drawing File Name BCIDD-ROT-UTL_IX-0011_XX_00-DR-CU-0003	Sheet Number 03 of 0	Status A	Rev M01

DO NOT SCALE USE FIGURED DIMENSIONS ONLY

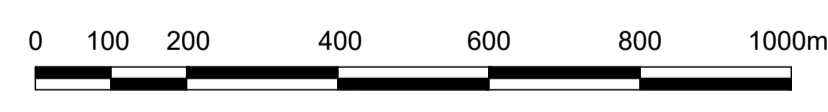
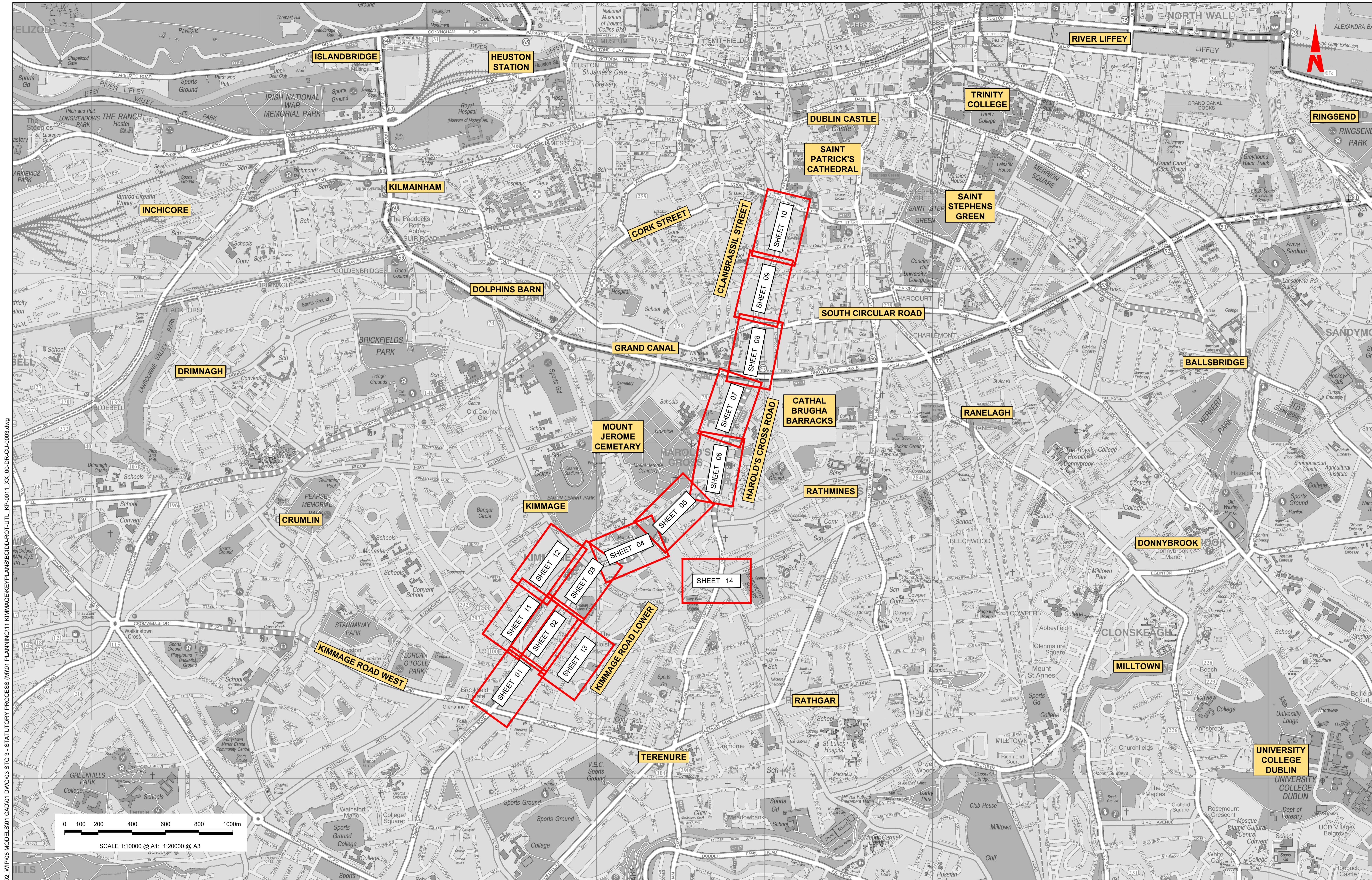

SCALE 1:10000 @ A1; 1:20000 @ A3

W:\000000\191119117-02\_WIP08 MODELS\01\_CAD\01 PLANNING\11\_KIMMAGE\KEYPLANS\BCIDD-ROT-UTL\_KP-0011\_XX\_00-DR-CU-0003.dwg

<p><b>Disclaimer</b></p> <p>a. © National Transport Authority (NTA) 2022. This drawing is confidential and the copyright in it is owned by NTA. This drawing must not be either loaned, copied or otherwise reproduced in whole or in part or used for any purpose without the prior permission of NTA.</p> <p>b. This drawing is to be used for the design element identified in the titleblock. Other information shown is to be considered indicative only. The drawing is to be read in conjunction with all other relevant design drawings.</p> <p>c. O.S. data used for plans are printed under © Ordnance Survey Ireland Government of Ireland. All rights reserved. Licence Number 2022/OSI_NMA_180 National Transport Authority. All elevations are in metres and relate to OSI Geoid Model (OSGM15) Mean Head. All Co-ordinates are in Irish Transverse Mercator Grid (ITM) as defined by OSI active local GPS station.</p> <p>d. Information concerning the position of apparatus shown on this drawing is based on drawings supplied by the utility owners and/or the utility works contractor, whilst every care has been taken in the preparation of this drawing, positions should be as to, or accept any liability or responsibility in relation to, the adequacy, accuracy, reasonableness or completeness of the information provided as part of this document or any matter on which the information is based (including but not limited to loss or damage arising as a result of reliance by recipients on the information or any part of it). Any liabilities are hereby expressly disclaimed.</p>		<p>Rev M01</p> <p>Date FEB 2023</p> <p>Drm CG</p> <p>Chk'd SMG</p> <p>App'd SMC</p>		<p>Description</p> <p>ISSUE FOR PHASE 4: PLANNING</p>		<p>Client</p> <p><b>NTA</b> Údarás Náisiúnta Iompair National Transport Authority</p>		<p>Engineering Designer</p> <p><b>CIROD</b> TYPSA</p>			<p>Programme Title</p> <p><b>BUSCONNECTS DUBLIN</b> <b>CORE BUS CORRIDORS INFRASTRUCTURE WORKS</b></p>		
<p>Date FEB 2023</p> <p>Scale 1:10,000 @ A1 1:20,000 @ A3</p>		<p>Drawn CG</p> <p>Checked SMG</p> <p>Approved SMG</p>		<p>Programme Code BCIDD</p> <p>Originator Code ROT</p>		<p>QMS Code</p>		<p>Drawing File Name</p> <p>BCIDD-ROT-UTL_KP-0011_XX_00-DR-CU-0003</p>			<p>Sheet Number 03 of 01</p> <p>Status A</p> <p>Rev M01</p>		

DO NOT SCALE USE FIGURED DIMENSIONS ONLY

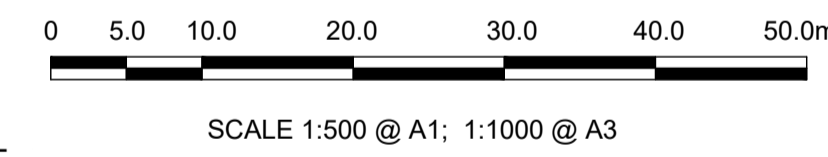
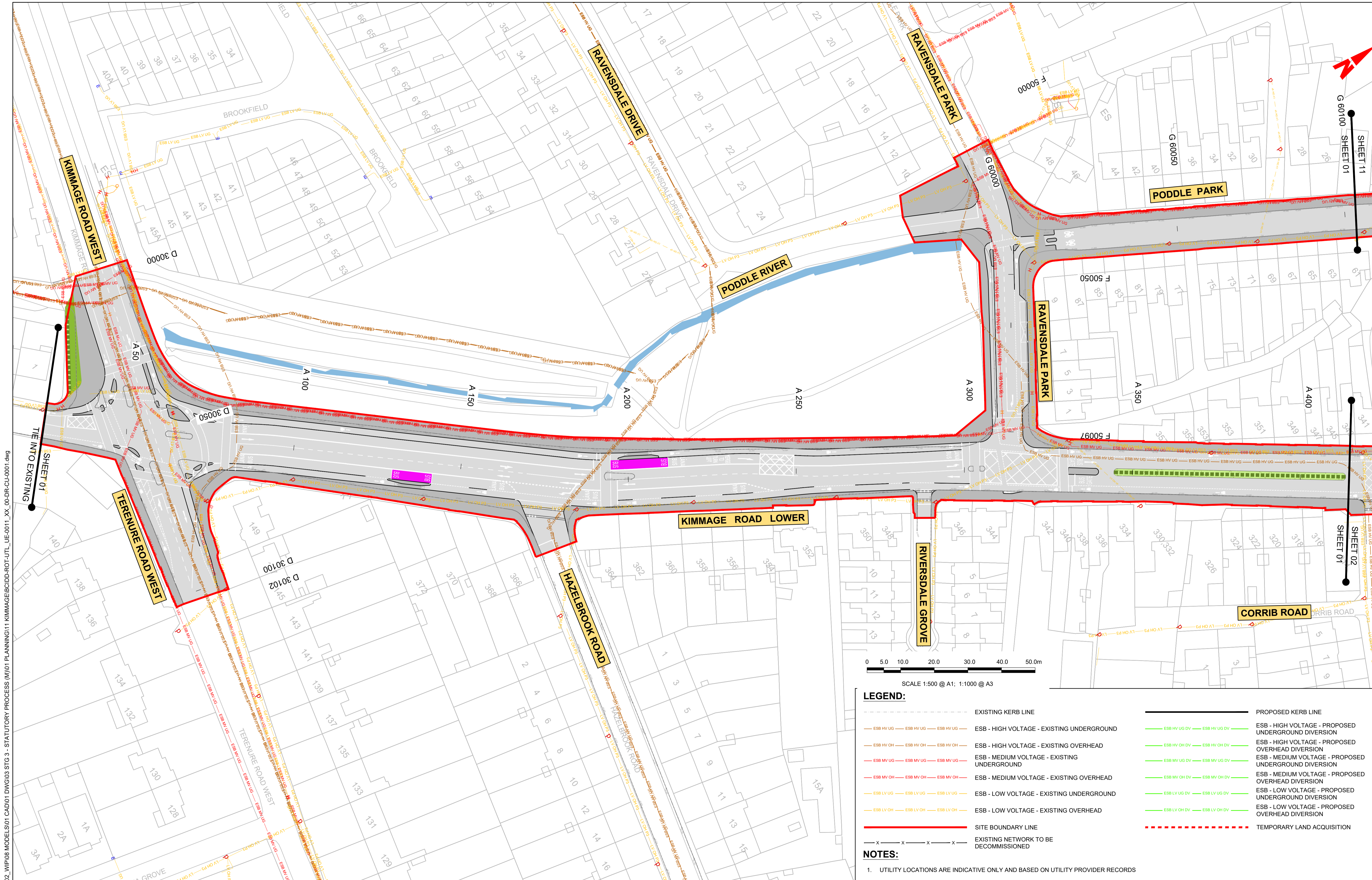

**LEGEND:**

---	EXISTING KERB LINE	---	PROPOSED KERB LINE
---	ESB - HIGH VOLTAGE - EXISTING UNDERGROUND	---	ESB - HIGH VOLTAGE - PROPOSED UNDERGROUND DIVERSION
---	ESB - HIGH VOLTAGE - EXISTING OVERHEAD	---	ESB - HIGH VOLTAGE - PROPOSED OVERHEAD DIVERSION
---	ESB - MEDIUM VOLTAGE - EXISTING UNDERGROUND	---	ESB - MEDIUM VOLTAGE - PROPOSED UNDERGROUND DIVERSION
---	ESB - MEDIUM VOLTAGE - EXISTING OVERHEAD	---	ESB - MEDIUM VOLTAGE - PROPOSED OVERHEAD DIVERSION
---	ESB - LOW VOLTAGE - EXISTING UNDERGROUND	---	ESB - LOW VOLTAGE - PROPOSED UNDERGROUND DIVERSION
---	ESB - LOW VOLTAGE - EXISTING OVERHEAD	---	ESB - LOW VOLTAGE - PROPOSED OVERHEAD DIVERSION
---	SITE BOUNDARY LINE	---	TEMPORARY LAND ACQUISITION
---	EXISTING NETWORK TO BE DECOMMISSIONED		

**NOTES:**

- UTILITY LOCATIONS ARE INDICATIVE ONLY AND BASED ON UTILITY PROVIDER RECORDS

W:\000000\111719117-02\_WIP\08 MODELS\01 CAD\01 PLANNING\11 KIMMAGE\BCIDD-ROT-UTL\_UE-0011\_XX\_00-DR-CU-0001.dwg

**Disclaimer**

a. © National Transport Authority (NTA) 2022. This drawing is confidential and the copyright in it is owned by NTA. This drawing must not be either loaned, copied or otherwise reproduced in whole or in part or used for any purpose without the prior permission of NTA.

b. This drawing is to be used for the design element identified in the titleblock. Other information shown is to be considered indicative only. The drawing is to be read in conjunction with all other relevant design drawings.

c. O.S. data used for plans are printed under © Ordnance Survey Ireland Government of Ireland. All rights reserved. Licence Number 2022/OSI\_NMA\_180 National Transport Authority. All elevations are in metres and relate to OSi Geoid Model (OSGM15) Mean Head. All Co-ordinates are in Irish Transverse Mercator Grid (ITM) as defined by OSI active local GPS station.

d. Information concerning the position of apparatus shown on this drawing is based on drawings supplied by the utility owners and/or the utility works contractor, whilst every care has been taken in the preparation of this drawing, positions should be taken as approximate and are intended for general guidance only and no representation is made by the NTA as to the accuracy, completeness, sufficiency or otherwise of this drawing and the position of the apparatus. The information contained herein does not purport to be comprehensive or final as the apparatus is subject to being altered and/or superceded. Recipients should not rely on this information. Any liabilities are hereby expressly disclaimed.

e. The information contained herein has been provided by the NTA but does not purport to be comprehensive or final. Recipients should not rely on the information. Neither the NTA nor any of its directors, officers, employees, agents, stakeholders or advisers make any representation or warranty as to, or accept any liability or responsibility in relation to, the adequacy, accuracy, reasonableness or completeness of the information provided as part of this document or any matter on which the information is based (including but not limited to loss or damage arising as a result of reliance by recipients on the information or any part of it). Any liabilities are hereby expressly disclaimed.



Rev	Date	Drn	Chk'd	App'd	Description
M01	FEB 2023	DS	EE	SMG	ISSUED FOR PHASE 4: PLANNING

Client <b>NTA</b> Udarás Náisiúnta Iompair National Transport Authority		Engineering Designer <b>CIROD</b> TYPSA		
Date FEB 2023	Scale 1:500 @ A1 1:1000 @ A3	Drawn DS	Checked EE	Approved SMG
Programme Code BCIDD	Originator Code ROT	QMS Code		

Programme Title <b>BUSCONNECTS DUBLIN CORE BUS CORRIDORS INFRASTRUCTURE WORKS</b>			
Drawing Title KIMMAGE TO CITY CENTRE CORE BUS CORRIDOR SCHEME ESB ASSET ALTERATIONS			
Drawing File Name BCIDD-ROT-UTL_UE-0011_XX_00-DR-CU-0001	Sheet Number 01 of 14	Status A	Rev M01

DO NOT SCALE USE FIGURED DIMENSIONS ONLY

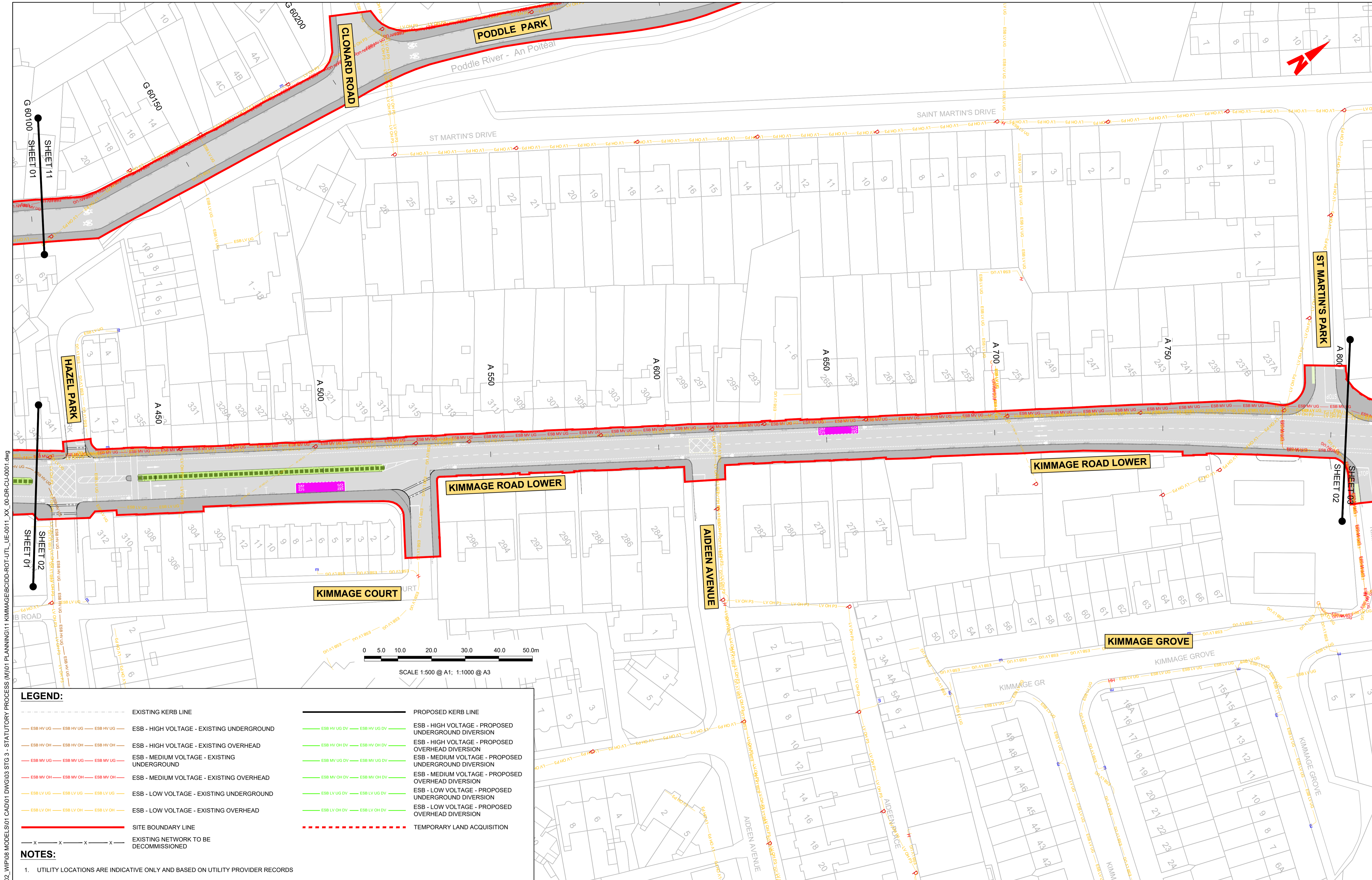

**LEGEND:**

	EXISTING KERB LINE		PROPOSED KERB LINE
	ESB - HIGH VOLTAGE - EXISTING UNDERGROUND		ESB - HIGH VOLTAGE - PROPOSED UNDERGROUND DIVERSION
	ESB - HIGH VOLTAGE - EXISTING OVERHEAD		ESB - HIGH VOLTAGE - PROPOSED OVERHEAD DIVERSION
	ESB - MEDIUM VOLTAGE - EXISTING UNDERGROUND		ESB - MEDIUM VOLTAGE - PROPOSED UNDERGROUND DIVERSION
	ESB - MEDIUM VOLTAGE - EXISTING OVERHEAD		ESB - MEDIUM VOLTAGE - PROPOSED OVERHEAD DIVERSION
	ESB - LOW VOLTAGE - EXISTING UNDERGROUND		ESB - LOW VOLTAGE - PROPOSED UNDERGROUND DIVERSION
	ESB - LOW VOLTAGE - EXISTING OVERHEAD		ESB - LOW VOLTAGE - PROPOSED OVERHEAD DIVERSION
	SITE BOUNDARY LINE		TEMPORARY LAND ACQUISITION
	EXISTING NETWORK TO BE DECOMMISSIONED		

**NOTES:**

- UTILITY LOCATIONS ARE INDICATIVE ONLY AND BASED ON UTILITY PROVIDER RECORDS

**Disclaimer:**

a. © National Transport Authority (NTA) 2022. This drawing is confidential and the copyright in it is owned by NTA. This drawing must not be either loaned, copied or otherwise reproduced in whole or in part or used for any purpose without the prior permission of NTA.

b. This drawing is to be used for the design element identified in the title block. Other information shown is to be considered indicative only. The drawing is to be read in conjunction with all other relevant design drawings.

c. O.S. data used for plans are printed under © Ordnance Survey Ireland Government of Ireland. All rights reserved. Licence Number 2022/OSI\_NMA\_180 National Transport Authority. All elevations are in metres and relate to OSI Grid Model (OSGM15) Mean Head. All Co-ordinates are in Irish Transverse Mercator Grid (ITM) as defined by OSI active local GPS station.

d. Information concerning the position of apparatus shown on this drawing is based on drawings supplied by the utility owners and/or the utility works contractor, whilst every care has been taken in the preparation of this drawing, positions should be taken as approximate and are intended for general guidance only and no representation is made by the NTA as to the accuracy, completeness, sufficiency or otherwise of this drawing and the position of the apparatus. The information contained herein does not purport to be comprehensive or final as the apparatus is subject to being altered and/or superceded. Recipients should not rely on this information. Any liabilities are hereby expressly disclaimed.

e. The information contained herein has been provided by the NTA but does not purport to be comprehensive or final. Recipients should not rely on the information. Neither the NTA nor any of its directors, officers, employees, agents, stakeholders or advisers make any representation or warranty as to, or accept any liability or responsibility in relation to, the adequacy, accuracy, reasonableness or completeness of the information provided as part of this document or any matter on which the information is based (including but not limited to loss or damage arising as a result of reliance by recipients on the information or any part of it). Any liabilities are hereby expressly disclaimed.



Rev	Date	Drm	Chk'd	App'd	Description
M01	FEB 2023	DS	EE	SMG	ISSUED FOR PHASE 4: PLANNING

Client

Údarás Náisiúnta Iompair  
National Transport Authority

Engineering Designer

Drawn DS  
Checked EE  
Approved SMG

Programme Title  
**BUSCONNECTS DUBLIN  
CORE BUS CORRIDORS INFRASTRUCTURE WORKS**

Drawing Title  
KIMMAGE TO CITY CENTRE CORE BUS CORRIDOR SCHEME  
ESB ASSET ALTERATIONS

Drawing File Name  
BCIDD-ROT-UTL\_UE-0011\_XX\_00-DR-CU-0002

Sheet Number  
02 of 14

Status  
A

Rev  
M01

DO NOT SCALE USE FIGURED DIMENSIONS ONLY

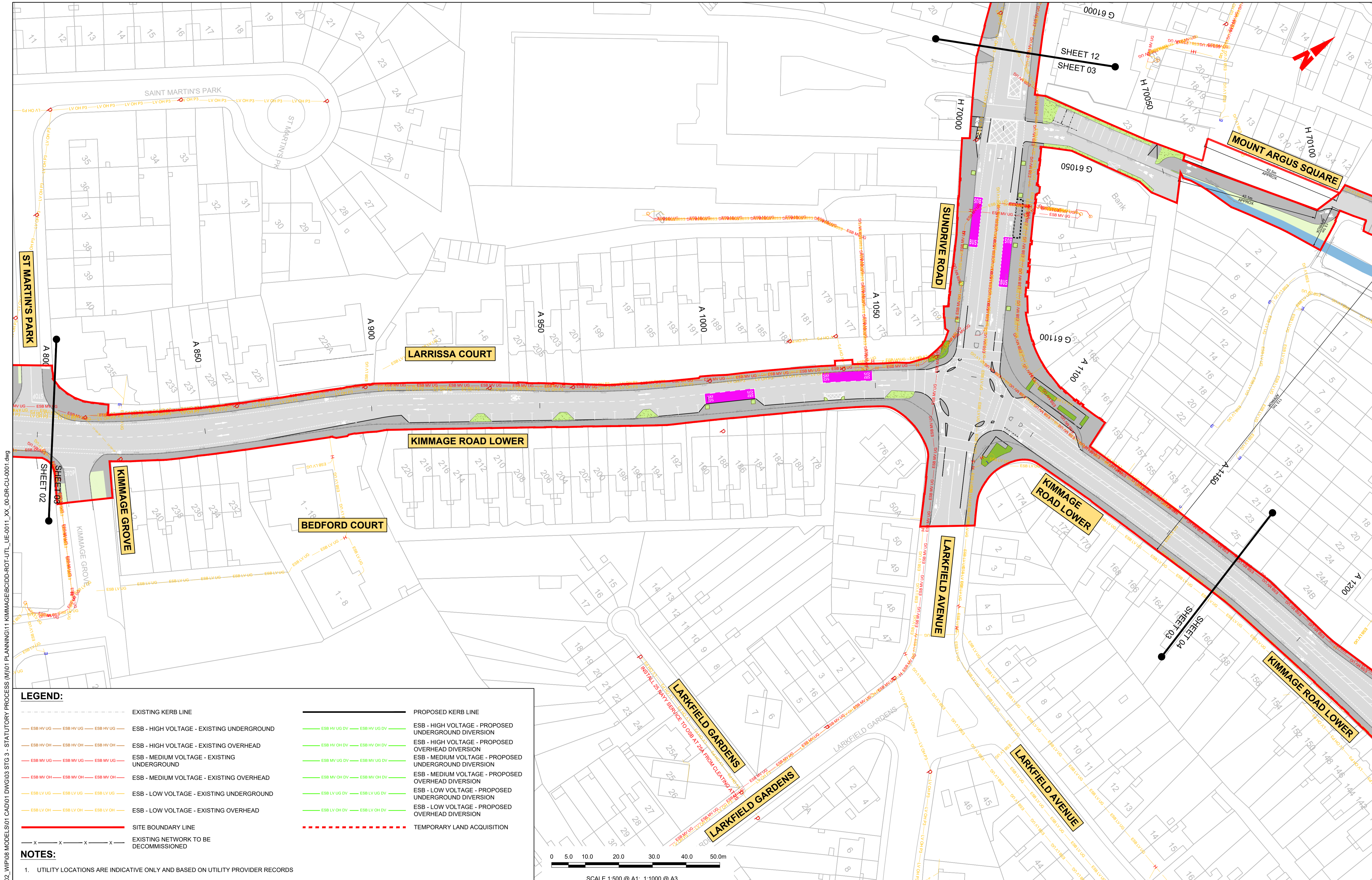

**LEGEND:**

	EXISTING KERB LINE		PROPOSED KERB LINE
	ESB - HIGH VOLTAGE - EXISTING UNDERGROUND		ESB - HIGH VOLTAGE - PROPOSED UNDERGROUND DIVERSION
	ESB - HIGH VOLTAGE - EXISTING OVERHEAD		ESB - HIGH VOLTAGE - PROPOSED OVERHEAD DIVERSION
	ESB - MEDIUM VOLTAGE - EXISTING UNDERGROUND		ESB - MEDIUM VOLTAGE - PROPOSED UNDERGROUND DIVERSION
	ESB - MEDIUM VOLTAGE - EXISTING OVERHEAD		ESB - MEDIUM VOLTAGE - PROPOSED OVERHEAD DIVERSION
	ESB - LOW VOLTAGE - EXISTING UNDERGROUND		ESB - LOW VOLTAGE - PROPOSED UNDERGROUND DIVERSION
	ESB - LOW VOLTAGE - EXISTING OVERHEAD		ESB - LOW VOLTAGE - PROPOSED OVERHEAD DIVERSION
	SITE BOUNDARY LINE		TEMPORARY LAND ACQUISITION
	EXISTING NETWORK TO BE DECOMMISSIONED		

**NOTES:**

- UTILITY LOCATIONS ARE INDICATIVE ONLY AND BASED ON UTILITY PROVIDER RECORDS

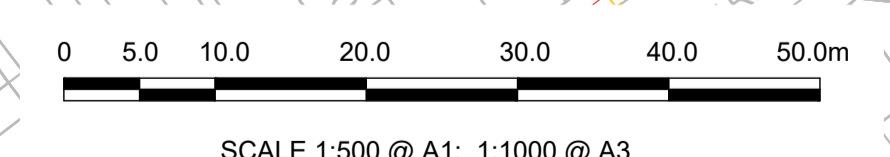

**Disclaimer**

a. © National Transport Authority (NTA) 2022. This drawing is confidential and the copyright in it is owned by NTA. This drawing must not be either loaned, copied or otherwise reproduced in whole or in part or used for any purpose without the prior permission of NTA.

b. This drawing is to be used for the design element identified in the title block. Other information shown is to be considered indicative only. The drawing is to be read in conjunction with all other relevant design drawings.

c. O.S. data used for plans are printed under © Ordnance Survey Ireland Government of Ireland. All rights reserved. Licence Number 2022/OSI\_NMA\_180 National Transport Authority. All elevations are in metres and relate to OSI Geoid Model (OSGM15) Mean Head. All Co-ordinates are in Irish Transverse Mercator Grid (ITM) as defined by OSI active local GPS station.

d. Information concerning the position of apparatus shown on this drawing is based on drawings supplied by the utility owners and/or the utility works contractor, whilst every care has been taken in the preparation of this drawing, positions should be taken as approximate and are intended for general guidance only and no representation is made by the NTA as to the accuracy, completeness, sufficiency or otherwise of this information. The information contained herein does not purport to be comprehensive or final as the apparatus is subject to being altered and/or superceded. Recipients should not rely on this information. Any liabilities are hereby expressly disclaimed.

e. The information contained herein has been provided by the NTA but does not purport to be comprehensive or final. Recipients should not rely on the information. Neither the NTA nor any of its directors, officers, employees, agents, stakeholders or advisers make any representation or warranty as to, or accept any liability or responsibility in relation to, the adequacy, accuracy, reasonableness or completeness of the information provided as part of this document or any matter on which the information is based (including but not limited to loss or damage arising as a result of reliance by recipients on the information or any part of it). Any liabilities are hereby expressly disclaimed.



Rev	Date	Drm	Chk'd	App'd	Description
M01	FEB 2023	DS	EE	SMG	ISSUED FOR PHASE 4: PLANNING

Client: **NTA**  
Udárás Náisiúnta Iompair  
National Transport Authority

Engineering Designer: **PROD**  
TYPSA

Date: FEB 2023  
Scale: 1:500 @ A1  
1:1000 @ A3

Programme Code: BCIDD  
Originator Code: ROT

Drawn: DS  
Checked: EE  
Approved: SMG

Programme Title: <b>BUSCONNECTS DUBLIN CORE BUS CORRIDORS INFRASTRUCTURE WORKS</b>			
Drawing Title: <b>KIMMAGE TO CITY CENTRE CORE BUS CORRIDOR SCHEME ESB ASSET ALTERATIONS</b>			
Drawing File Name: BCIDD-ROT-UTL_UE-0011_XX_00-DR-CU-0003	Sheet Number: 03 of 14	Status: A	Rev: M01

DO NOT SCALE USE FIGURED DIMENSIONS ONLY

\\produbp1\j\2019\1917\1917-02\_WIP\08 MODELS\01 CAD\01 DWG\03 STG 3 - STATUTORY PROCESS (M)\01 PLANNING\11 KIMMAGE\BIDD-ROT-UTL\_UE-0011\_XX\_00-DR-CU-0001.dwg

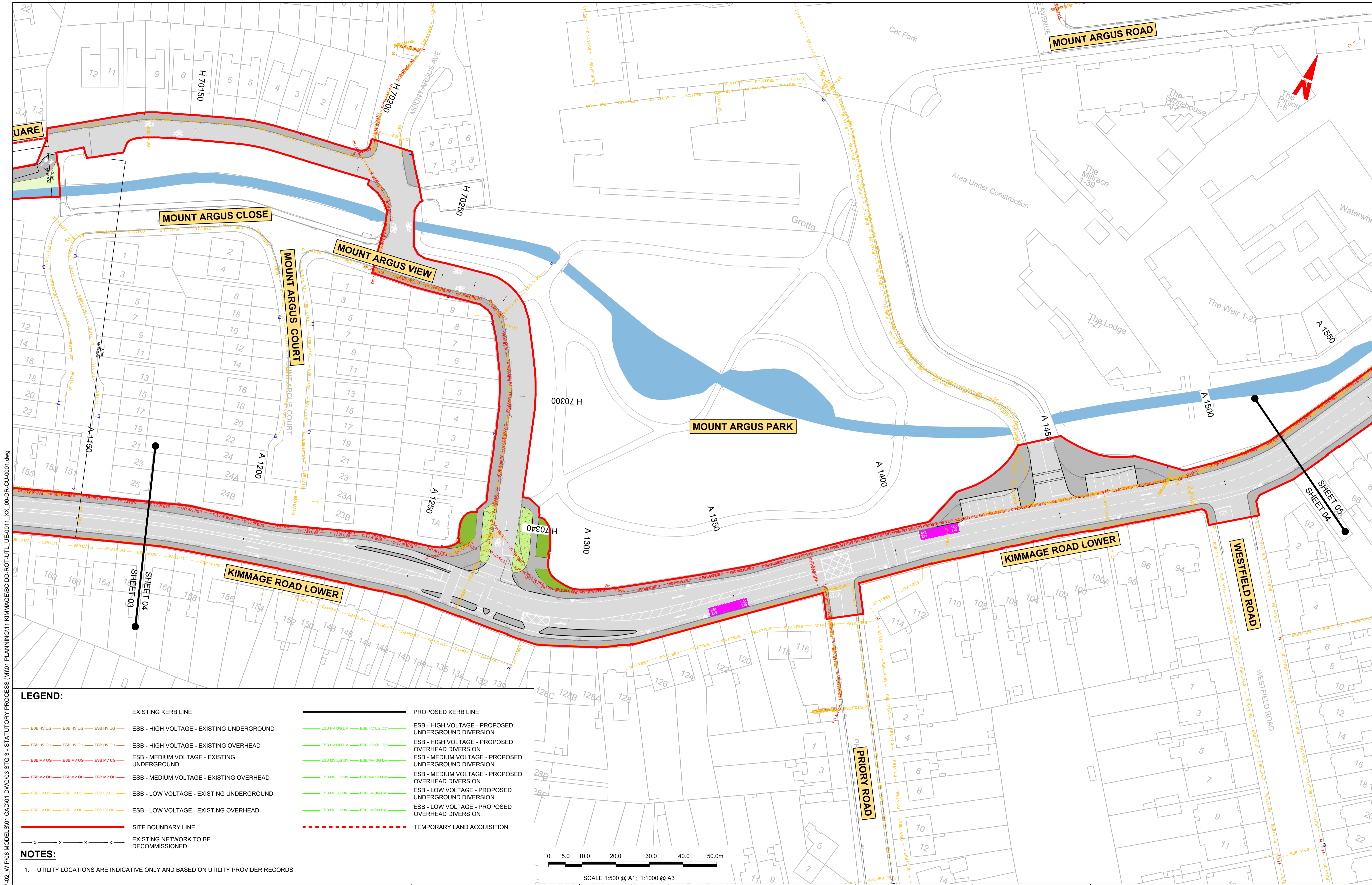

**LEGEND:**

	EXISTING KERB LINE		PROPOSED KERB LINE
	ESB - HIGH VOLTAGE - EXISTING UNDERGROUND		ESB - HIGH VOLTAGE - PROPOSED UNDERGROUND DIVERSION
	ESB - HIGH VOLTAGE - EXISTING OVERHEAD		ESB - HIGH VOLTAGE - PROPOSED OVERHEAD DIVERSION
	ESB - MEDIUM VOLTAGE - EXISTING UNDERGROUND		ESB - MEDIUM VOLTAGE - PROPOSED UNDERGROUND DIVERSION
	ESB - MEDIUM VOLTAGE - EXISTING OVERHEAD		ESB - MEDIUM VOLTAGE - PROPOSED OVERHEAD DIVERSION
	ESB - LOW VOLTAGE - EXISTING UNDERGROUND		ESB - LOW VOLTAGE - PROPOSED UNDERGROUND DIVERSION
	ESB - LOW VOLTAGE - EXISTING OVERHEAD		ESB - LOW VOLTAGE - PROPOSED OVERHEAD DIVERSION
	SITE BOUNDARY LINE		TEMPORARY LAND ACQUISITION
	EXISTING NETWORK TO BE DECOMMISSIONED		

**NOTES:**

- UTILITY LOCATIONS ARE INDICATIVE ONLY AND BASED ON UTILITY PROVIDER RECORDS

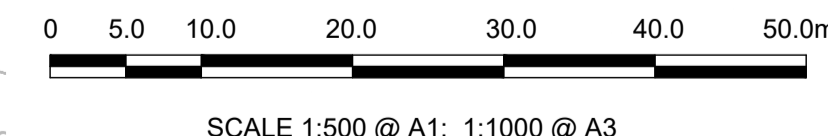

**Disclaimer:**

a. © National Transport Authority (NTA) 2022. This drawing is confidential and the copyright in it is owned by NTA. This drawing must not be either loaned, copied or otherwise reproduced in whole or in part or used for any purpose without the prior permission of NTA.

b. This drawing is to be used for the design element identified in the titlebox. Other information shown is to be considered indicative only. The drawing is to be read in conjunction with all other relevant design drawings.

c. O.S. data used for plans are printed under © Ordnance Survey Ireland Government of Ireland. All rights reserved. Licence Number 2022/OSI\_NMA\_180 National Transport Authority. All elevations are in metres and relate to OSI Geoid Model (OSGM15) Mean Head. All Co-ordinates are in Irish Transverse Mercator Grid (ITM) as defined by OSI active local GPS station.

d. Information concerning the position of apparatus shown on this drawing is based on drawings supplied by the utility owners and/or the utility works contractor, whilst every care has been taken in the preparation of this drawing, positions should be taken as approximate and are intended for general guidance only and no representation is made by the NTA as to the accuracy, completeness, sufficiency or otherwise of this drawing and the position of the apparatus. The information contained herein does not purport to be comprehensive or final as the apparatus is subject to being altered and/or superceded. Recipients should not rely on this information. Any liabilities are hereby expressly disclaimed.

e. The information contained herein has been provided by the NTA but does not purport to be comprehensive or final. Recipients should not rely on the information. Neither the NTA nor any of its directors, officers, employees, agents, stakeholders or advisers make any representation or warranty as to, or accept any liability or responsibility in relation to, the adequacy, accuracy, reasonableness or completeness of the information provided as part of this document or any matter on which the information is based (including but not limited to loss or damage arising as a result of reliance by recipients on the information or any part of it). Any liabilities are hereby expressly disclaimed.



Rev	Date	Drm	Chk'd	App'd	Description
M01	FEB 2023	DS	EE	SMG	ISSUED FOR PHASE 4: PLANNING

Client: **NTA**  
Udarás Náisiúnta Iompair  
National Transport Authority

Engineering Designer: **PROD**  
TYPSA

Date: FEB 2023 | Scale: 1:500 @ A1, 1:1000 @ A3 | Drawn: DS | Checked: EE | Approved: SMG

Programme Code: BCIDD | Originator Code: ROT | QMS Code:

Programme Title: <b>BUSCONNECTS DUBLIN CORE BUS CORRIDORS INFRASTRUCTURE WORKS</b>			
Drawing Title: <b>KIMMAGE TO CITY CENTRE CORE BUS CORRIDOR SCHEME ESB ASSET ALTERATIONS</b>			
Drawing File Name: BCIDD-ROT-UTL_UE-0011_XX_00-DR-CU-0004	Sheet Number: 04 of 14	Status: A	Rev: M01

DO NOT SCALE USE FIGURED DIMENSIONS ONLY

\\produbp1\U201919\17119117-02\_WIP\08 MODELS\01 CAD\01 DWG\03 STG 3 - STATUTORY PROCESS (M)\01 PLANNING\11 KIMMAGE\BIDD-ROT-UTL\_UE-0011\_XX\_00-DR-CU-0001.dwg

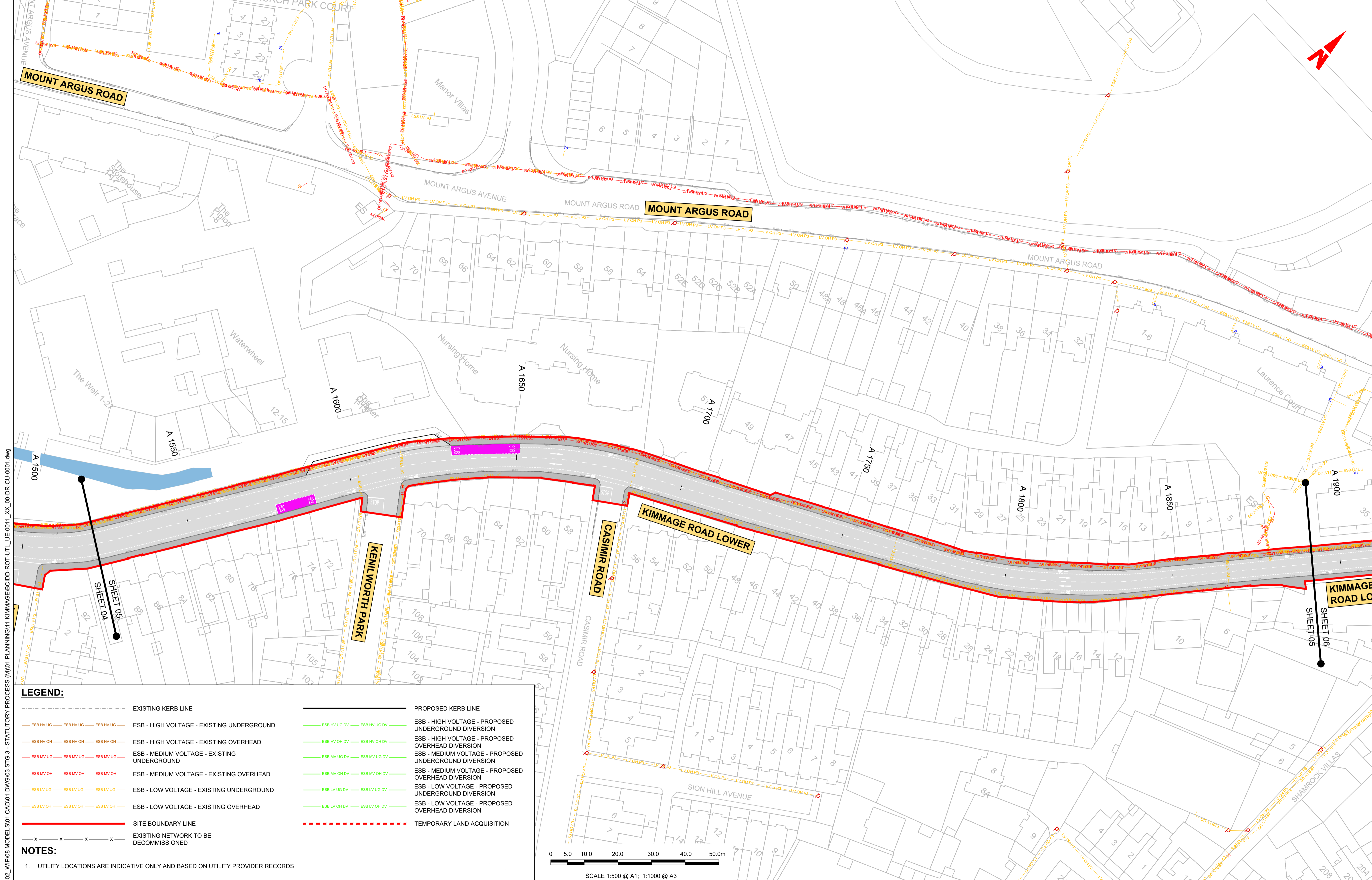

**LEGEND:**

---	EXISTING KERB LINE	---	PROPOSED KERB LINE
---	ESB - HIGH VOLTAGE - EXISTING UNDERGROUND	---	ESB - HIGH VOLTAGE - PROPOSED UNDERGROUND DIVERSION
---	ESB - HIGH VOLTAGE - EXISTING OVERHEAD	---	ESB - HIGH VOLTAGE - PROPOSED OVERHEAD DIVERSION
---	ESB - MEDIUM VOLTAGE - EXISTING UNDERGROUND	---	ESB - MEDIUM VOLTAGE - PROPOSED UNDERGROUND DIVERSION
---	ESB - MEDIUM VOLTAGE - EXISTING OVERHEAD	---	ESB - MEDIUM VOLTAGE - PROPOSED OVERHEAD DIVERSION
---	ESB - LOW VOLTAGE - EXISTING UNDERGROUND	---	ESB - LOW VOLTAGE - PROPOSED UNDERGROUND DIVERSION
---	ESB - LOW VOLTAGE - EXISTING OVERHEAD	---	ESB - LOW VOLTAGE - PROPOSED OVERHEAD DIVERSION
---	SITE BOUNDARY LINE	---	TEMPORARY LAND ACQUISITION
---	EXISTING NETWORK TO BE DECOMMISSIONED		

**NOTES:**

- UTILITY LOCATIONS ARE INDICATIVE ONLY AND BASED ON UTILITY PROVIDER RECORDS

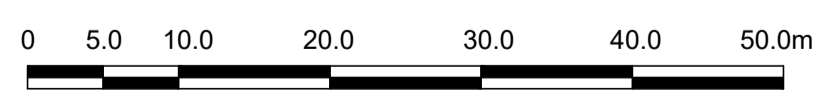

SCALE 1:500 @ A1; 1:1000 @ A3

**Disclaimer**

a. © National Transport Authority (NTA) 2022. This drawing is confidential and the copyright in it is owned by NTA. This drawing must not be either loaned, copied or otherwise reproduced in whole or in part or used for any purpose without the prior permission of NTA.

b. This drawing is to be used for the design element identified in the titlebox. Other information shown is to be considered indicative only. The drawing is to be read in conjunction with all other relevant design drawings.

c. O.S. data used for plans are printed under © Ordnance Survey Ireland Government of Ireland. All rights reserved. Licence Number 2022/OS/IMA\_150 National Transport Authority. All elevations are in metres and relate to OSi Geoid Model (OSGM15) Mean Head. All Co-ordinates are in Irish Transverse Mercator Grid (ITM) as defined by OSI active local GPS station.

d. Information concerning the position of apparatus shown on this drawing is based on drawings supplied by the utility owners and/or the utility works contractor, whilst every care has been taken in the preparation of this drawing, positions should be taken as approximate and are intended for general guidance only and no representation is made by the NTA as to the accuracy, completeness, sufficiency or otherwise of this drawing and the position of the apparatus. The information contained herein does not purport to be comprehensive or final as the apparatus is subject to being altered and/or superceded. Recipients should not rely on this information. Any liabilities are hereby expressly disclaimed.

e. The information contained herein has been provided by the NTA but does not purport to be comprehensive or final. Recipients should not rely on the information. Neither the NTA nor any of its directors, officers, employees, agents, stakeholders or advisers make any representation or warranty as to, or accept any liability or responsibility in relation to the adequacy, accuracy, reasonableness or completeness of the information provided as part of this document or any matter on which the information is based (including but not limited to loss or damage arising as a result of reliance by recipients on the information on any part of it). Any liabilities are hereby expressly disclaimed.



Rev	Date	Drn	Chk'd	App'd	Description
M01	FEB 2023	DS	EE	SMG	ISSUED FOR PHASE 4; PLANNING

Client

Udarás Náisiúnta Iompair  
National Transport Authority

Engineering Designer

Checked: EE  
Approved: SMG

Programme Title  
**BUSCONNECTS DUBLIN  
CORE BUS CORRIDORS INFRASTRUCTURE WORKS**

Drawing Title  
KIMMAGE TO CITY CENTRE CORE BUS CORRIDOR SCHEME  
ESB ASSET ALTERATIONS

Drawing File Name: BCIDD-ROT-UTL\_UE-0011\_XX\_00-DR-CU-0005

Sheet Number: 05 of 14

Status: A

Rev: M01

DO NOT SCALE USE FIGURED DIMENSIONS ONLY



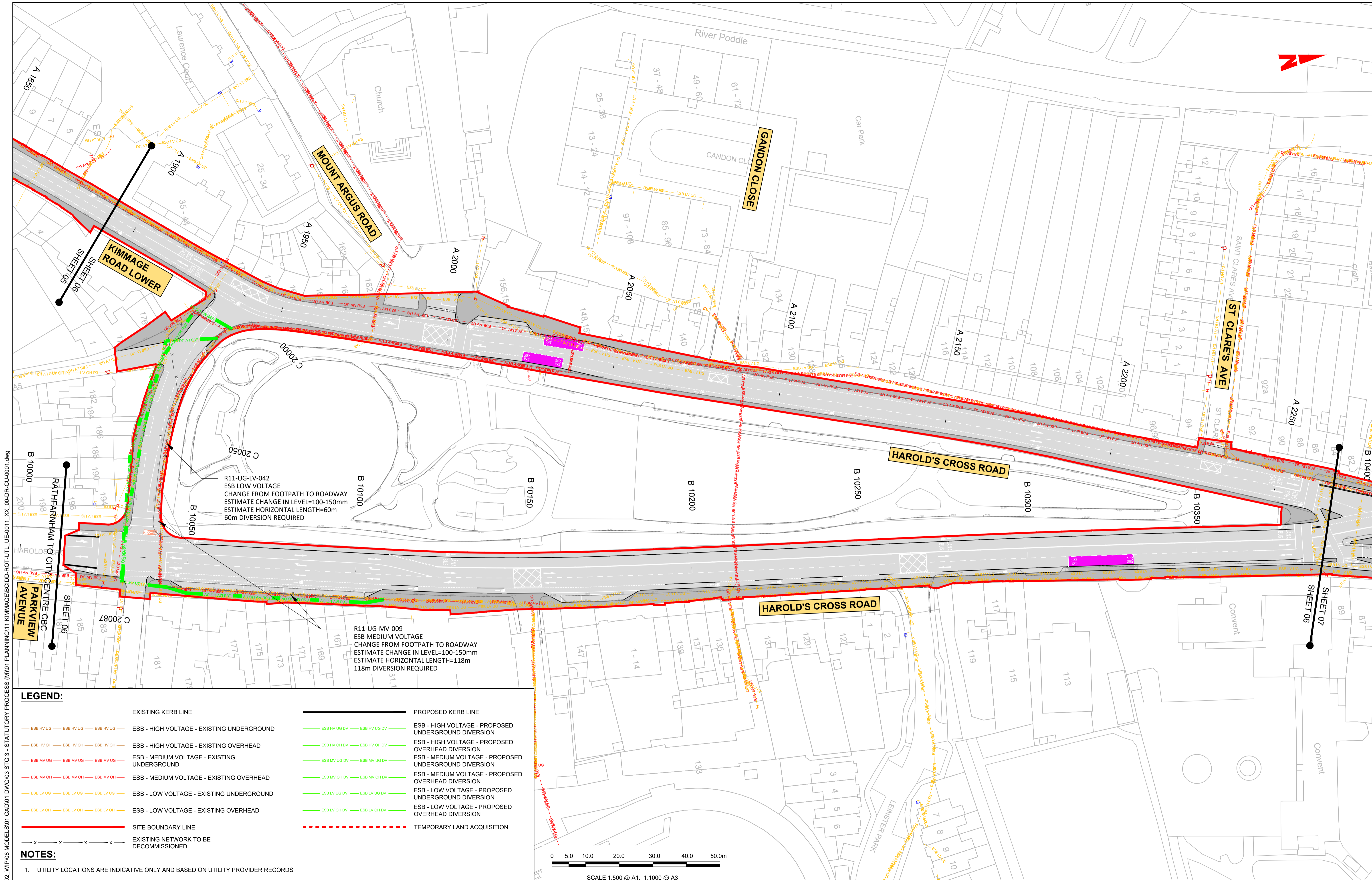

W:\odubhp\11719117-02\_WIP\08 MODELS\01 CAD\01 PLANNING\11 KIMMAGE\BCIDD-ROT-UTL\_UE-0011\_XX\_00-DR-CU-0001.dwg  
 2023/02/03 11:17:02 WIP\08 MODELS\01 CAD\01 PLANNING\11 KIMMAGE\BCIDD-ROT-UTL\_UE-0011\_XX\_00-DR-CU-0001.dwg

**LEGEND:**

---	EXISTING KERB LINE	---	PROPOSED KERB LINE
---	ESB - HIGH VOLTAGE - EXISTING UNDERGROUND	---	ESB - HIGH VOLTAGE - PROPOSED UNDERGROUND DIVERSION
---	ESB - HIGH VOLTAGE - EXISTING OVERHEAD	---	ESB - HIGH VOLTAGE - PROPOSED OVERHEAD DIVERSION
---	ESB - MEDIUM VOLTAGE - EXISTING UNDERGROUND	---	ESB - MEDIUM VOLTAGE - PROPOSED UNDERGROUND DIVERSION
---	ESB - MEDIUM VOLTAGE - EXISTING OVERHEAD	---	ESB - MEDIUM VOLTAGE - PROPOSED OVERHEAD DIVERSION
---	ESB - LOW VOLTAGE - EXISTING UNDERGROUND	---	ESB - LOW VOLTAGE - PROPOSED UNDERGROUND DIVERSION
---	ESB - LOW VOLTAGE - EXISTING OVERHEAD	---	ESB - LOW VOLTAGE - PROPOSED OVERHEAD DIVERSION
---	SITE BOUNDARY LINE	---	TEMPORARY LAND ACQUISITION
---	EXISTING NETWORK TO BE DECOMMISSIONED		

**NOTES:**

1. UTILITY LOCATIONS ARE INDICATIVE ONLY AND BASED ON UTILITY PROVIDER RECORDS

R11-UG-LV-042  
 ESB LOW VOLTAGE  
 CHANGE FROM FOOTPATH TO ROADWAY  
 ESTIMATE CHANGE IN LEVEL=100-150mm  
 ESTIMATE HORIZONTAL LENGTH=60m  
 60m DIVERSION REQUIRED

R11-UG-MV-009  
 ESB MEDIUM VOLTAGE  
 CHANGE FROM FOOTPATH TO ROADWAY  
 ESTIMATE CHANGE IN LEVEL=100-150mm  
 ESTIMATE HORIZONTAL LENGTH=118m  
 118m DIVERSION REQUIRED



SCALE 1:500 @ A1; 1:1000 @ A3

**Disclaimer:**

a. © National Transport Authority (NTA) 2022. This drawing is confidential and the copyright in it is owned by NTA. This drawing must not be either loaned, copied or otherwise reproduced in whole or in part or used for any purpose without the prior permission of NTA.

b. This drawing is to be used for the design element identified in the titlebox. Other information shown is to be considered indicative only. The drawing is to be read in conjunction with all other relevant design drawings.

c. O.S. data used for plans are printed under © Ordnance Survey Ireland Government of Ireland. All rights reserved. Licence Number 2022/OSI\_NMA\_180 National Transport Authority. All elevations are in metres and relate to OSI Geoid Model (OSGM15) Mean Head. All Co-ordinates are in Irish Transverse Mercator Grid (ITM) as defined by OSI active local GPS station.

d. Information concerning the position of apparatus shown on this drawing is based on drawings supplied by the utility owners and/or the utility works contractor, whilst every care has been taken in the preparation of this drawing, positions should be taken as approximate and are intended for general guidance only and no representation is made by the NTA as to the accuracy, completeness, sufficiency or otherwise of this drawing and the position of the apparatus. The information contained herein does not purport to be comprehensive or final as the apparatus is subject to being altered and/or superceded. Recipients should not rely on this information. Any liabilities are hereby expressly disclaimed.

e. The information contained herein has been provided by the NTA but does not purport to be comprehensive or final. Recipients should not rely on the information. Neither the NTA nor any of its directors, officers, employees, agents, stakeholders or advisers make any representation or warranty as to, or accept any liability or responsibility in relation to, the adequacy, accuracy, reasonableness or completeness of the information provided as part of this document or any matter on which the information is based (including but not limited to loss or damage arising as a result of reliance by recipients on the information or any part of it). Any liabilities are hereby expressly disclaimed.



Rev	Date	Drm	Chk'd	App'd	Description
M01	FEB 2023	DS	EE	SMG	ISSUED FOR PHASE 4: PLANNING

Client  
**NTA**  
 Údarás Náisiúnta Iompair  
 National Transport Authority

Engineering Designer  
**FIROD**  
 TYPSA

Programme Title <b>BUSCONNECTS DUBLIN CORE BUS CORRIDORS INFRASTRUCTURE WORKS</b>	
Drawing Title KIMMAGE TO CITY CENTRE CORE BUS CORRIDOR SCHEME ESB ASSET ALTERATIONS	
Drawing File Name BCIDD-ROT-UTL_UE-0011_XX_00-DR-CU-0006	Sheet Number 06 of 14
Status A	Rev M01

DO NOT SCALE USE FIGURED DIMENSIONS ONLY

**LEGEND:**

	EXISTING KERB LINE		PROPOSED KERB LINE
	ESB - HIGH VOLTAGE - EXISTING UNDERGROUND		ESB - HIGH VOLTAGE - PROPOSED UNDERGROUND DIVERSION
	ESB - HIGH VOLTAGE - EXISTING OVERHEAD		ESB - HIGH VOLTAGE - PROPOSED OVERHEAD DIVERSION
	ESB - MEDIUM VOLTAGE - EXISTING UNDERGROUND		ESB - MEDIUM VOLTAGE - PROPOSED UNDERGROUND DIVERSION
	ESB - MEDIUM VOLTAGE - EXISTING OVERHEAD		ESB - MEDIUM VOLTAGE - PROPOSED OVERHEAD DIVERSION
	ESB - LOW VOLTAGE - EXISTING UNDERGROUND		ESB - LOW VOLTAGE - PROPOSED UNDERGROUND DIVERSION
	ESB - LOW VOLTAGE - EXISTING OVERHEAD		ESB - LOW VOLTAGE - PROPOSED OVERHEAD DIVERSION
	SITE BOUNDARY LINE		TEMPORARY LAND ACQUISITION
	EXISTING NETWORK TO BE DECOMMISSIONED		

**NOTES:**

- UTILITY LOCATIONS ARE INDICATIVE ONLY AND BASED ON UTILITY PROVIDER RECORDS

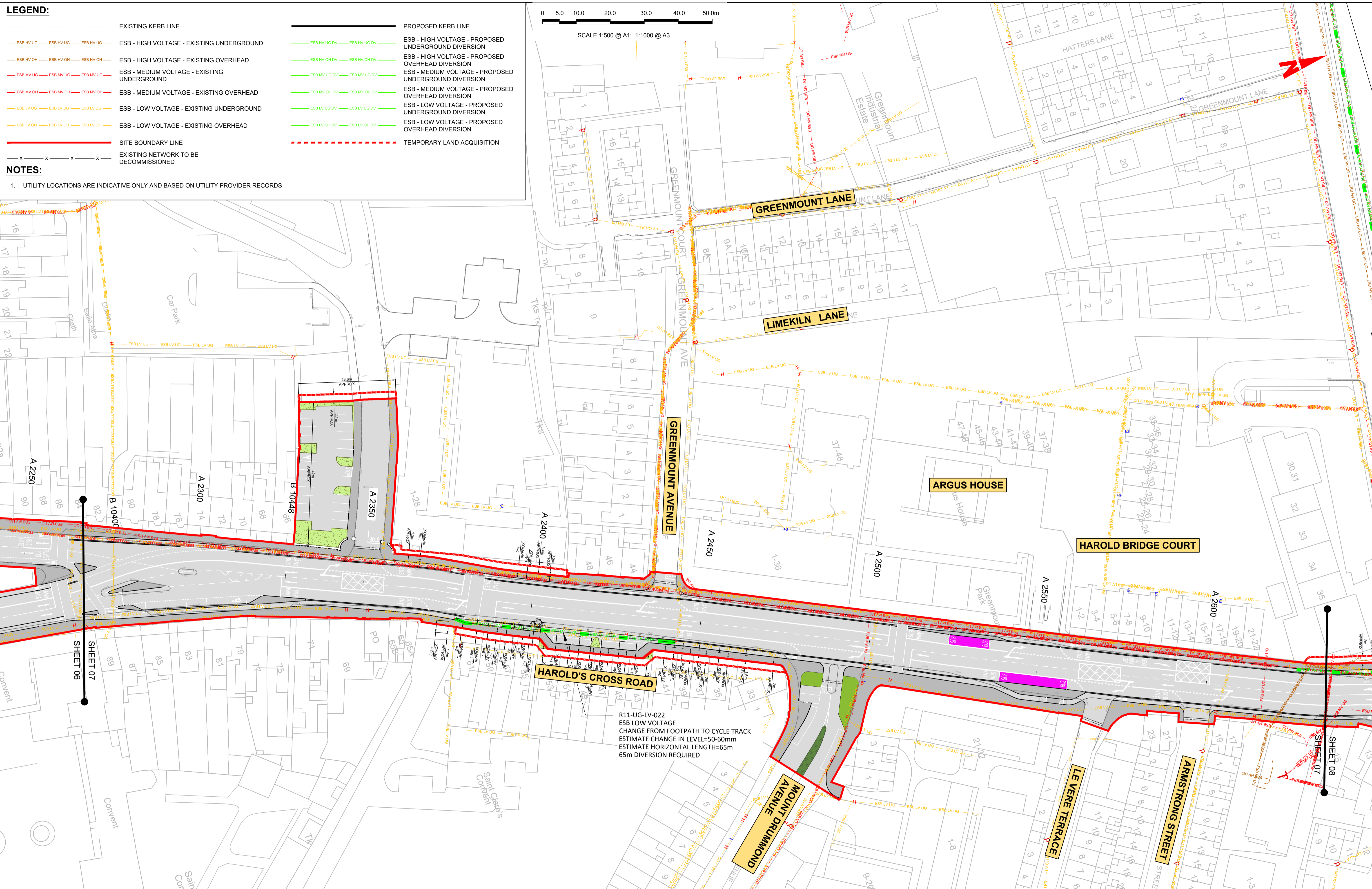
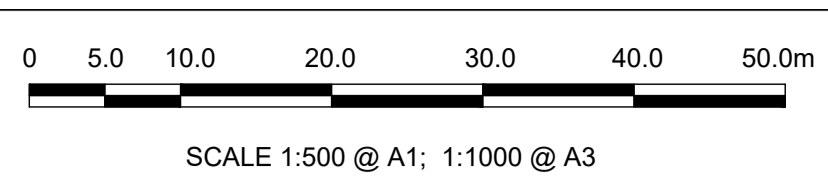

**Disclaimer**

a. © National Transport Authority (NTA) 2022. This drawing is confidential and the copyright in it is owned by NTA. This drawing must not be either loaned, copied or otherwise reproduced in whole or in part or used for any purpose without the prior permission of NTA.

b. This drawing is to be used for the design element identified in the title block. Other information shown is to be considered indicative only. The drawing is to be read in conjunction with all other relevant design drawings.

c. O.S. data used for plans are printed under © Ordnance Survey Ireland Government of Ireland. All rights reserved. Licence Number 2022/OSI\_NMA\_180 National Transport Authority. All elevations are in metres and relate to OSI Geoid Model (OSGM15) Mean Head. All Co-ordinates are in Irish Transverse Mercator Grid (ITM) as defined by OSI active local GPS station.

d. Information concerning the position of apparatus shown on this drawing is based on drawings supplied by the utility owners and/or the utility works contractor, whilst every care has been taken in the preparation of this drawing, positions should be taken as approximate and are intended for general guidance only and no representation is made by the NTA as to the accuracy, completeness, sufficiency or otherwise of this information. The information contained herein does not purport to be comprehensive or final as the apparatus is subject to being altered and/or superceded. Recipients should not rely on this information. Any liabilities are hereby expressly disclaimed.

e. The information contained herein has been provided by the NTA but does not purport to be comprehensive or final. Recipients should not rely on the information. Neither the NTA nor any of its directors, officers, employees, agents, stakeholders or advisers make any representation or warranty as to, or accept any liability or responsibility in relation to, the adequacy, accuracy, reasonableness or completeness of the information provided as part of this document or any matter on which the information is based (including but not limited to loss or damage arising as a result of reliance by recipients on the information or any part of it). Any liabilities are hereby expressly disclaimed.

**Project Ireland 2040**  
 Building Ireland's Future

Rev	Date	Drn	Chkd	App'd	Description
M01	FEB 2023	DS	EE	SMG	ISSUED FOR PHASE 4: PLANNING

Client		Engineering Designer		Programme Title	
 Údarás Náisiúnta Iompair National Transport Authority		 IROD TYPSA		<b>BUSCONNECTS DUBLIN</b> <b>CORE BUS CORRIDORS INFRASTRUCTURE WORKS</b>	
Date	Scale	Drawn	Checked	Approved	
FEB 2023	1:500 @ A1 1:1000 @ A3	DS	EE	SMG	
Programme Code	Originator Code	QMS Code		Drawing File Name	Sheet Number
BCIDD	ROT			BCIDD-ROT-UTL_UE-0011_XX_00-DR-CU-0007	07 of 14
Status	Rev				
A	M01				

Date	Scale	Drawn	Checked	Approved	
FEB 2023	1:500 @ A1 1:1000 @ A3	DS	EE	SMG	
Programme Code	Originator Code	QMS Code		Drawing File Name	
BCIDD	ROT			BCIDD-ROT-UTL_UE-0011_XX_00-DR-CU-0007	
Status	Rev				
A	M01				

Date	Scale	Drawn	Checked	Approved	
FEB 2023	1:500 @ A1 1:1000 @ A3	DS	EE	SMG	
Programme Code	Originator Code	QMS Code		Drawing File Name	
BCIDD	ROT			BCIDD-ROT-UTL_UE-0011_XX_00-DR-CU-0007	
Status	Rev				
A	M01				

DO NOT SCALE USE FIGURED DIMENSIONS ONLY

W:\000000\19117117-02\_WIP\08 MODELS\01 CAD\01 DWG\03 STG 3 - STATUTORY PROCESS (M)\01 PLANNING\11 KIMMAGE\BCIDD-ROT-UTL\_UE-0011\_XX\_00-DR-CU-0001.dwg

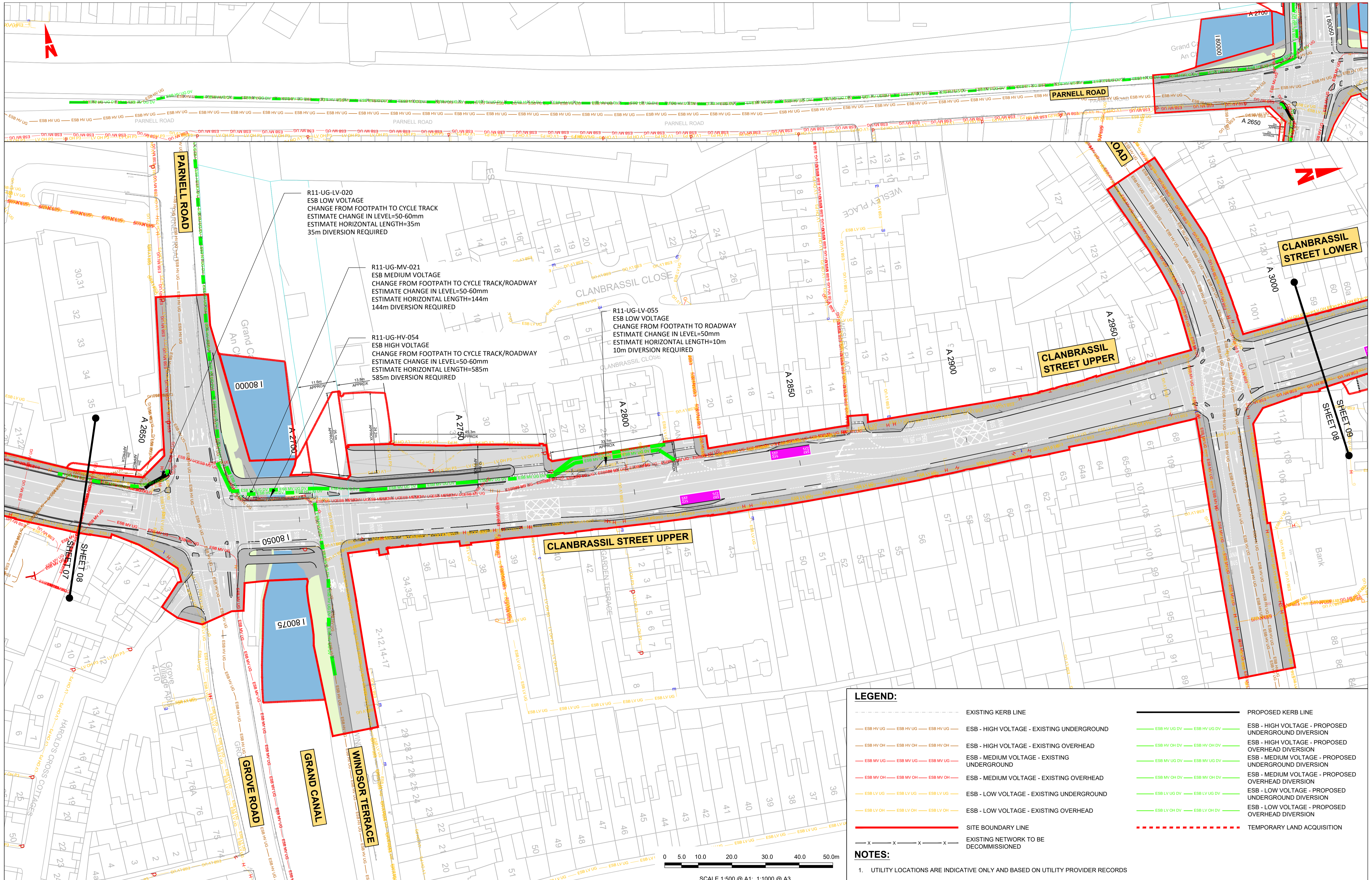

**LEGEND:**

	EXISTING KERB LINE		PROPOSED KERB LINE
	ESB HV UG	ESB HV UG	ESB - HIGH VOLTAGE - EXISTING UNDERGROUND
	ESB HV UG DV	ESB HV UG DV	ESB - HIGH VOLTAGE - PROPOSED UNDERGROUND DIVERSION
	ESB HV OH	ESB HV OH	ESB - HIGH VOLTAGE - EXISTING OVERHEAD
	ESB HV OH DV	ESB HV OH DV	ESB - HIGH VOLTAGE - PROPOSED OVERHEAD DIVERSION
	ESB MV UG	ESB MV UG	ESB - MEDIUM VOLTAGE - EXISTING UNDERGROUND
	ESB MV UG DV	ESB MV UG DV	ESB - MEDIUM VOLTAGE - PROPOSED UNDERGROUND DIVERSION
	ESB MV OH	ESB MV OH	ESB - MEDIUM VOLTAGE - EXISTING OVERHEAD
	ESB MV OH DV	ESB MV OH DV	ESB - MEDIUM VOLTAGE - PROPOSED OVERHEAD DIVERSION
	ESB LV UG	ESB LV UG	ESB - LOW VOLTAGE - EXISTING UNDERGROUND
	ESB LV UG DV	ESB LV UG DV	ESB - LOW VOLTAGE - PROPOSED UNDERGROUND DIVERSION
	ESB LV OH	ESB LV OH	ESB - LOW VOLTAGE - EXISTING OVERHEAD
	ESB LV OH DV	ESB LV OH DV	ESB - LOW VOLTAGE - PROPOSED OVERHEAD DIVERSION
	SITE BOUNDARY LINE		TEMPORARY LAND ACQUISITION
	EXISTING NETWORK TO BE DECOMMISSIONED		

**NOTES:**

- UTILITY LOCATIONS ARE INDICATIVE ONLY AND BASED ON UTILITY PROVIDER RECORDS

**Disclaimer**

a. © National Transport Authority (NTA) 2022. This drawing is confidential and the copyright in it is owned by NTA. This drawing must not be either loaned, copied or otherwise reproduced in whole or in part or used for any purpose without the prior permission of NTA.

b. This drawing is to be used for the design element identified in the titlebox. Other information shown is to be considered indicative only. The drawing is to be read in conjunction with all other relevant design drawings.

c. O.S. data used for plans are printed under © Ordnance Survey Ireland Government of Ireland. All rights reserved. Licence Number 2022/OSI\_NMA\_180 National Transport Authority. All elevations are in metres and relate to OSI Geoid Model (OSGM15) Mean Head. All Co-ordinates are in Irish Transverse Mercator Grid (ITM) as defined by OSI active local GPS station.

d. Information concerning the position of apparatus shown on this drawing is based on drawings supplied by the utility owners and/or the utility works contractor, whilst every care has been taken in the preparation of this drawing, positions should be taken as approximate and are intended for general guidance only and no representation is made by the NTA as to the accuracy, completeness, sufficiency or otherwise of this drawing and the position of the apparatus. The information contained herein does not purport to be comprehensive or final as the apparatus is subject to being altered and/or superceded. Recipients should not rely on this information. Any liabilities are hereby expressly disclaimed.

e. The information contained herein has been provided by the NTA but does not purport to be comprehensive or final. Recipients should not rely on the information. Neither the NTA nor any of its directors, officers, employees, agents, stakeholders or advisers make any representation or warranty as to, or accept any liability or responsibility in relation to, the adequacy, accuracy, reasonableness or completeness of the information provided as part of this document or any matter on which the information is based (including but not limited to loss or damage arising as a result of reliance by recipients on the information or any part of it). Any liabilities are hereby expressly disclaimed.

Rev	Date	Dm	Chk'd	App'd	Description
M01	FEB 2023	DS	EE	SMG	ISSUED FOR PHASE 4: PLANNING

Client <b>NTA</b> Údarás Náisiúnta Iompair National Transport Authority		Engineering Designer <b>FIROD</b> TYPSA		Programme Title <b>BUSCONNECTS DUBLIN CORE BUS CORRIDORS INFRASTRUCTURE WORKS</b>	
Date FEB 2023	Scale 1:500 @ A1 1:1000 @ A3	Drawn DS	Checked EE	Approved SMG	Drawing Title KIMMAGE TO CITY CENTRE (CORE BUS CORRIDOR SCHEME ESB ASSET ALTERATIONS)
Programme Code BCIDD	Originator Code ROT	QMS Code	Drawing File Name BCIDD-ROT-UTL_UE-0011_XX_00-DR-CU-0008	Sheet Number 08 of 14	Status A
				Rev M01	



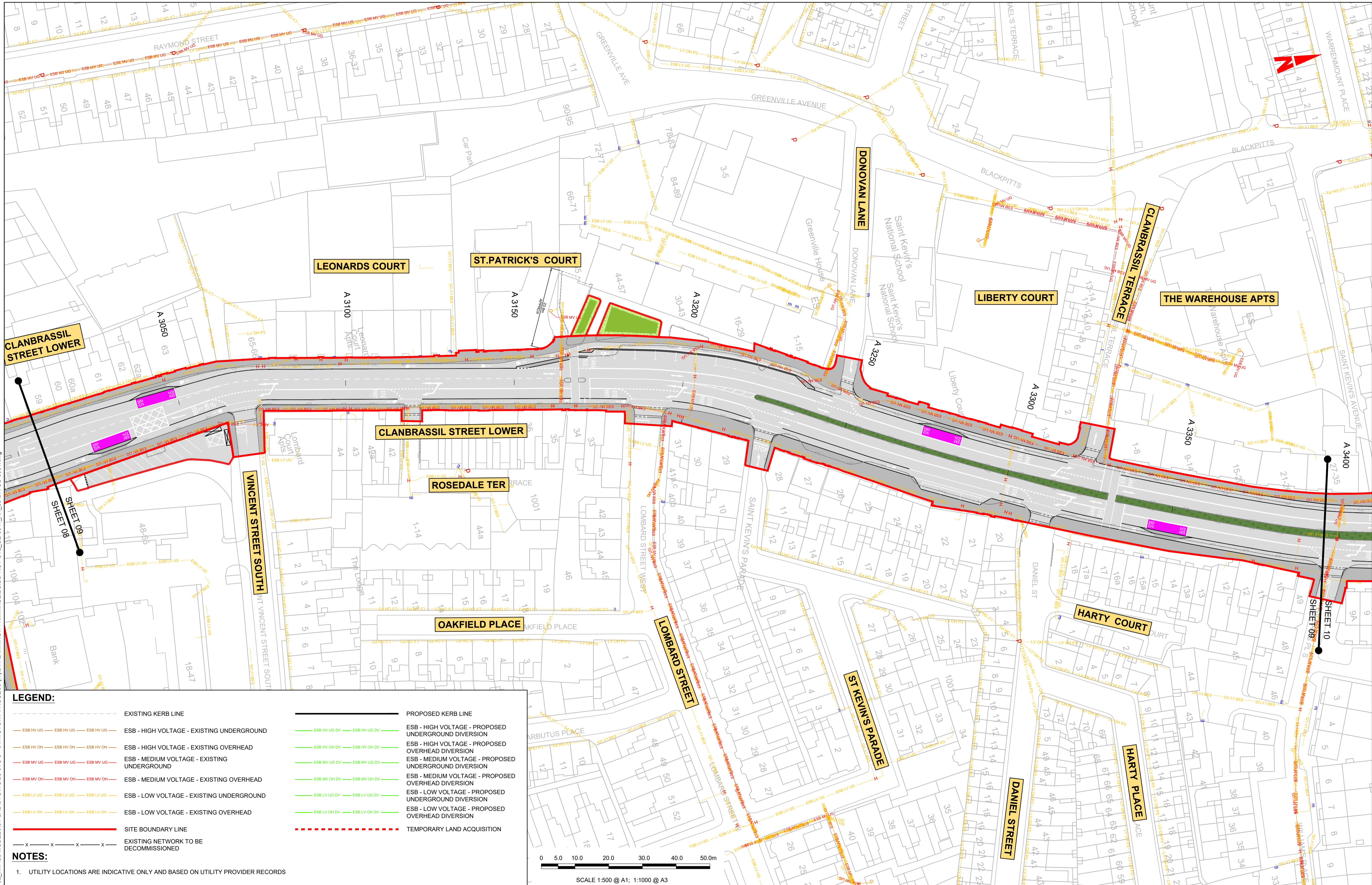

**LEGEND:**

	EXISTING KERB LINE		PROPOSED KERB LINE
	ESB - HIGH VOLTAGE - EXISTING UNDERGROUND		ESB - HIGH VOLTAGE - PROPOSED UNDERGROUND DIVERSION
	ESB - HIGH VOLTAGE - EXISTING OVERHEAD		ESB - HIGH VOLTAGE - PROPOSED OVERHEAD DIVERSION
	ESB - MEDIUM VOLTAGE - EXISTING UNDERGROUND		ESB - MEDIUM VOLTAGE - PROPOSED UNDERGROUND DIVERSION
	ESB - MEDIUM VOLTAGE - EXISTING OVERHEAD		ESB - MEDIUM VOLTAGE - PROPOSED OVERHEAD DIVERSION
	ESB - LOW VOLTAGE - EXISTING UNDERGROUND		ESB - LOW VOLTAGE - PROPOSED UNDERGROUND DIVERSION
	ESB - LOW VOLTAGE - EXISTING OVERHEAD		ESB - LOW VOLTAGE - PROPOSED OVERHEAD DIVERSION
	SITE BOUNDARY LINE		TEMPORARY LAND ACQUISITION
	EXISTING NETWORK TO BE DECOMMISSIONED		

**NOTES:**

- UTILITY LOCATIONS ARE INDICATIVE ONLY AND BASED ON UTILITY PROVIDER RECORDS

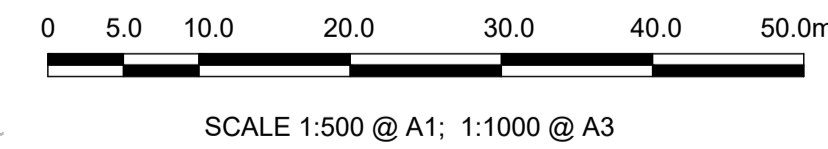

**Disclaimer:**

a. © National Transport Authority (NTA) 2022. This drawing is confidential and the copyright in it is owned by NTA. This drawing must not be either loaned, copied or otherwise reproduced in whole or in part or used for any purpose without the prior permission of NTA.

b. This drawing is to be used for the design element identified in the titleblock. Other information shown is to be considered indicative only. The drawing is to be read in conjunction with all other relevant design drawings.

c. O.S. data used for plans are printed under © Ordnance Survey Ireland Government of Ireland. All rights reserved. Licence Number 2022/OSI\_NMA\_180 National Transport Authority. All elevations are in metres and relate to OSI Geoid Model (OSGM15) Mean Head. All Co-ordinates are in Irish Transverse Mercator Grid (ITM) as defined by OSI active local GPS station.

d. Information concerning the position of apparatus shown on this drawing is based on drawings supplied by the utility owners and/or the utility works contractor, whilst every care has been taken in the preparation of this drawing, positions should be taken as approximate and are intended for general guidance only and no representation is made by the NTA as to the accuracy, completeness, sufficiency or otherwise of this drawing and the position of the apparatus. The information contained herein does not purport to be comprehensive or final as the apparatus is subject to being altered and/or superseded. Recipients should not rely on this information. Any liabilities are hereby expressly disclaimed.

e. The information contained herein has been provided by the NTA but does not purport to be comprehensive or final. Recipients should not rely on the information. Neither the NTA nor any of its directors, officers, employees, agents, stakeholders or advisers make any representation or warranty as to, or accept any liability or responsibility in relation to, the adequacy, accuracy, reasonableness or completeness of the information provided as part of this document or any matter on which the information is based (including but not limited to loss or damage arising as a result of reliance by recipients on the information or any part of it). Any liabilities are hereby expressly disclaimed.



Rev	Date	Drm	Chk'd	App'd	Description
M01	FEB 2023	DS	EE	SMG	ISSUED FOR PHASE 4: PLANNING

Client: **NTA**  
Údaráis Náisiúnta Iompair  
National Transport Authority

Engineering Designer: **PROD**  
TYPSA

Date: FEB 2023  
Scale: 1:500 @ A1  
1:1000 @ A3

Programme Code: BCIDD  
Originator Code: ROT

Drawn: DS  
Checked: EE  
Approved: SMG

Programme Title	<b>BUSCONNECTS DUBLIN CORE BUS CORRIDORS INFRASTRUCTURE WORKS</b>		
Drawing Title	KIMMAGE TO CITY CENTRE CORE BUS CORRIDOR SCHEME ESB ASSET ALTERATIONS		
Drawing File Name	BCIDD-ROT-UTL_UE-0011_XX_00-DR-CU-0009	Sheet Number	09 of 14
Status	A	Rev	M01

DO NOT SCALE USE FIGURED DIMENSIONS ONLY

\\produbp1u20191917117-02\_WIP08 MODELS01 CAD01 DWG03 STG 3 - STATUTORY PROCESS (M)01 PLANNING11 KIMMAGEBCIDD-ROT-UTL\_UE-0011\_XX\_00-DR-CU-0001.dwg

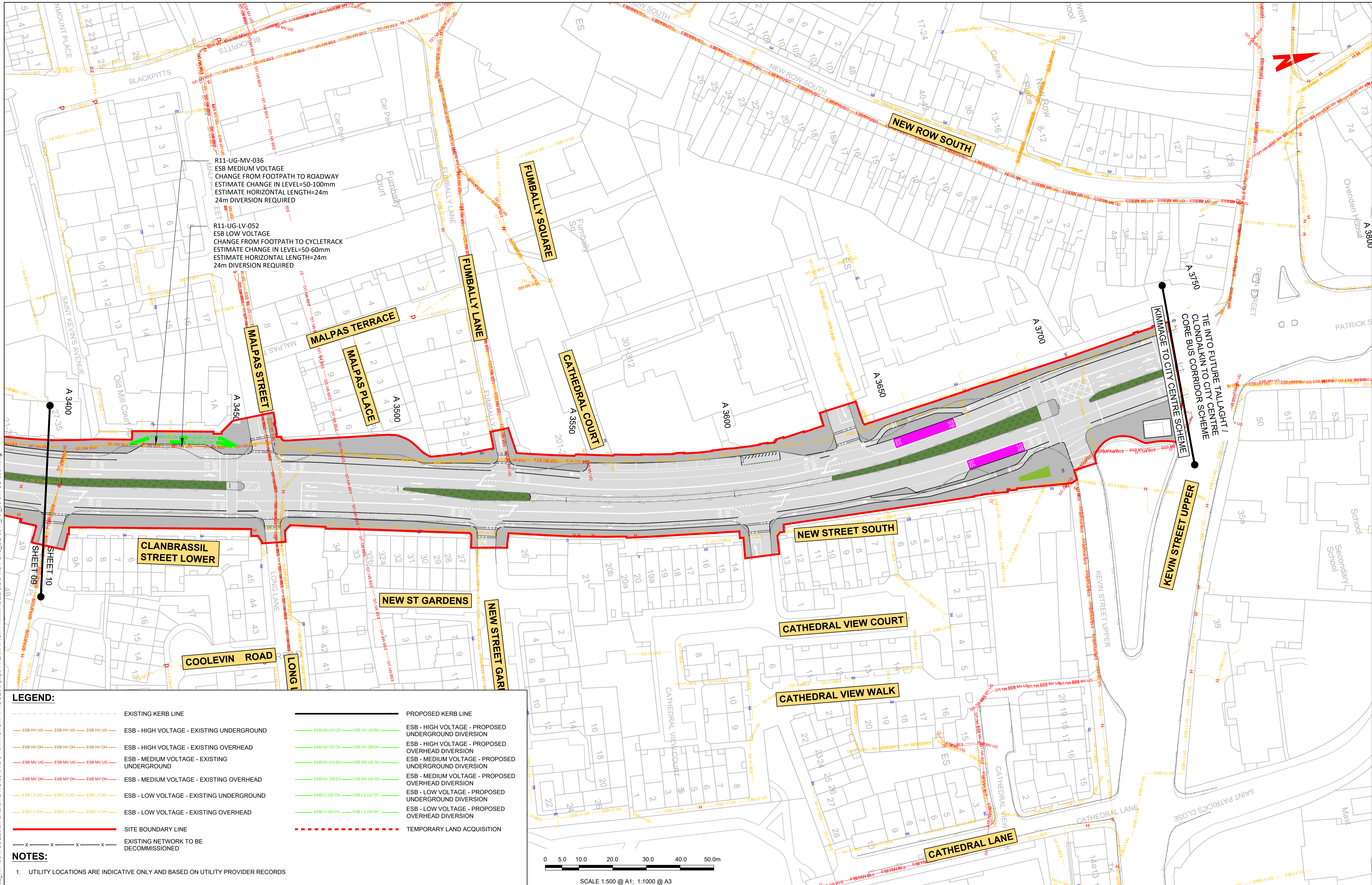

R11-UG-MV-036  
 ESB MEDIUM VOLTAGE  
 CHANGE FROM FOOTPATH TO ROADWAY  
 ESTIMATE CHANGE IN LEVEL=50-100mm  
 ESTIMATE HORIZONTAL LENGTH=24m  
 24m DIVERSION REQUIRED

R11-UG-LV-052  
 ESB LOW VOLTAGE  
 CHANGE FROM FOOTPATH TO CYCLETRACK  
 ESTIMATE CHANGE IN LEVEL=50-60mm  
 ESTIMATE HORIZONTAL LENGTH=24m  
 24m DIVERSION REQUIRED

**LEGEND:**

	EXISTING KERB LINE		PROPOSED KERB LINE
	ESB - HIGH VOLTAGE - EXISTING UNDERGROUND		ESB - HIGH VOLTAGE - PROPOSED UNDERGROUND DIVERSION
	ESB - HIGH VOLTAGE - EXISTING OVERHEAD		ESB - HIGH VOLTAGE - PROPOSED OVERHEAD DIVERSION
	ESB - MEDIUM VOLTAGE - EXISTING UNDERGROUND		ESB - MEDIUM VOLTAGE - PROPOSED UNDERGROUND DIVERSION
	ESB - MEDIUM VOLTAGE - EXISTING OVERHEAD		ESB - MEDIUM VOLTAGE - PROPOSED OVERHEAD DIVERSION
	ESB - LOW VOLTAGE - EXISTING UNDERGROUND		ESB - LOW VOLTAGE - PROPOSED UNDERGROUND DIVERSION
	ESB - LOW VOLTAGE - EXISTING OVERHEAD		ESB - LOW VOLTAGE - PROPOSED OVERHEAD DIVERSION
	SITE BOUNDARY LINE		TEMPORARY LAND ACQUISITION
	EXISTING NETWORK TO BE DECOMMISSIONED		

**NOTES:**

- UTILITY LOCATIONS ARE INDICATIVE ONLY AND BASED ON UTILITY PROVIDER RECORDS



SCALE 1:500 @ A1; 1:1000 @ A3

**Disclaimer:**

a. © National Transport Authority (NTA) 2022. This drawing is confidential and the copyright in it is owned by NTA. This drawing must not be either loaned, copied or otherwise reproduced in whole or in part or used for any purpose without the prior permission of NTA.

b. This drawing is to be used for the design element identified in the title block. Other information shown is to be considered indicative only. The drawing is to be read in conjunction with all other relevant design drawings.

c. O.S. data used for plans are printed under © Ordnance Survey Ireland Government of Ireland. All rights reserved. Licence Number 2022/OSI\_NMA\_180 National Transport Authority. All elevations are in metres and relate to OSi Geoid Model (OSGM15) Mean Head. All Co-ordinates are in Irish Transverse Mercator Grid (ITM) as defined by OSI active local GPS station.

d. Information concerning the position of apparatus shown on this drawing is based on drawings supplied by the utility owners and/or the utility works contractor, whilst every care has been taken in the preparation of this drawing, positions should be taken as approximate and are intended for general guidance only and no representation is made by the NTA as to the accuracy, completeness, sufficiency or otherwise of this drawing and the position of the apparatus. The information contained herein does not purport to be comprehensive or final as the apparatus is subject to being altered and/or superceded. Recipients should not rely on this information. Any liabilities are hereby expressly disclaimed.

The information contained herein has been provided by the NTA but does not purport to be comprehensive or final. Recipients should not rely on the information. Neither the NTA nor any of its directors, officers, employees, agents, stakeholders or advisers make any representation or warranty as to, or accept any liability or responsibility in relation to, the adequacy, accuracy, reasonableness or completeness of the information provided as part of this document or any matter on which the information is based (including but not limited to loss or damage arising as a result of reliance by recipients on the information or any part of it). Any liabilities are hereby expressly disclaimed.

Building Ireland's Future

Rev	Date	Dm	Chk'd	App'd	Description
M01	FEB 2023	DS	EE	SMG	ISSUED FOR PHASE 4: PLANNING

Client

Údarás Náisiúnta Iompair  
National Transport Authority

Engineering Designer		Programme Title	
		<b>BUSCONNECTS DUBLIN CORE BUS CORRIDORS INFRASTRUCTURE WORKS</b>	
Date	Scale	Drawn	Checked
FEB 2023	1:500 @ A1 1:1000 @ A3	DS	EE
Programme Code	Originator Code	QMS Code	Approved
BCIDD	ROT		SMG

Drawing Title	KIMMAGE TO CITY CENTRE CORE BUS CORRIDOR SCHEME ESB ASSET ALTERATIONS		
Drawing File Name	Sheet Number	Status	Rev
BCIDD-ROT-UTL_UE-0011_XX_00-DR-CU-0010	10 of 14	A	M01

DO NOT SCALE USE FIGURED DIMENSIONS ONLY

**LEGEND:**

	EXISTING KERB LINE		PROPOSED KERB LINE
	ESB HV UG - EXISTING UNDERGROUND		ESB - HIGH VOLTAGE - PROPOSED UNDERGROUND DIVERSION
	ESB HV OH - EXISTING OVERHEAD		ESB - HIGH VOLTAGE - PROPOSED OVERHEAD DIVERSION
	ESB MV UG - EXISTING UNDERGROUND		ESB - MEDIUM VOLTAGE - PROPOSED UNDERGROUND DIVERSION
	ESB MV OH - EXISTING OVERHEAD		ESB - MEDIUM VOLTAGE - PROPOSED OVERHEAD DIVERSION
	ESB LV UG - EXISTING UNDERGROUND		ESB - LOW VOLTAGE - PROPOSED UNDERGROUND DIVERSION
	ESB LV OH - EXISTING OVERHEAD		ESB - LOW VOLTAGE - PROPOSED OVERHEAD DIVERSION
	SITE BOUNDARY LINE		TEMPORARY LAND ACQUISITION
	EXISTING NETWORK TO BE DECOMMISSIONED		

**NOTES:**

- UTILITY LOCATIONS ARE INDICATIVE ONLY AND BASED ON UTILITY PROVIDER RECORDS

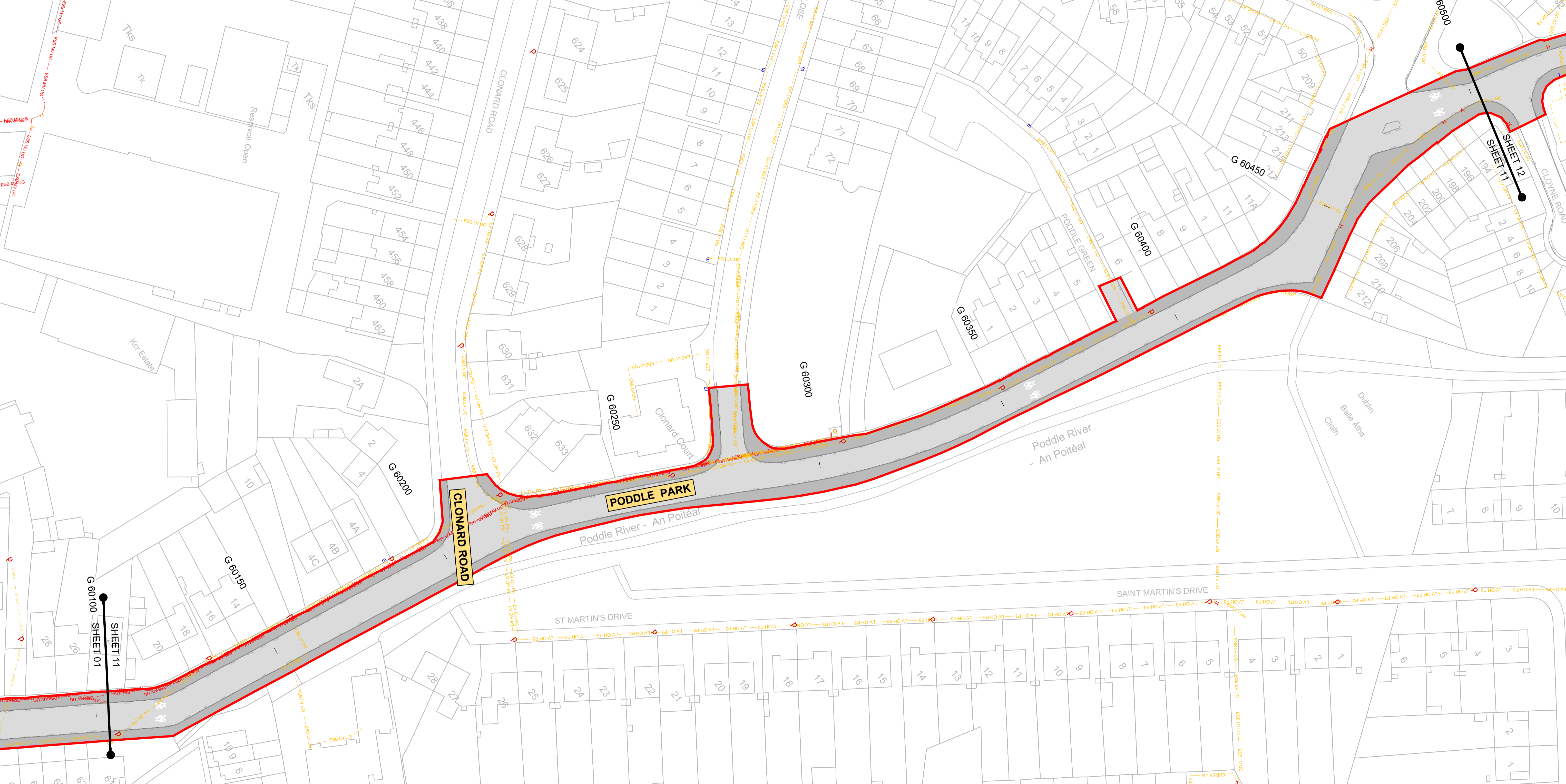
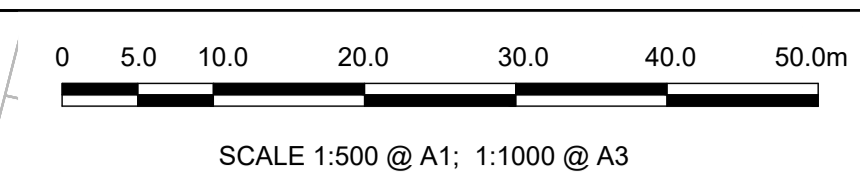

**Disclaimer**

a. © National Transport Authority (NTA) 2022. This drawing is confidential and the copyright in it is owned by NTA. This drawing must not be either loaned, copied or otherwise reproduced in whole or in part or used for any purpose without the prior permission of NTA.

b. This drawing is to be used for the design element identified in the titleblock. Other information shown is to be considered indicative only. The drawing is to be read in conjunction with all other relevant design drawings.

c. O.S. data used for plans are printed under © Ordnance Survey Ireland Government of Ireland. All rights reserved. Licence Number 2022/OSI\_NMA\_180 National Transport Authority. All elevations are in metres and relate to OSI Geoid Model (OSGM15) Malin Head. All Co-ordinates are in Irish Transverse Mercator Grid (ITM) as defined by OSI active local GPS station.

d. Information concerning the position of apparatus shown on this drawing is based on drawings supplied by the utility owners and/or the utility works contractor, whilst every care has been taken in the preparation of this drawing, positions should be taken as approximate and are intended for general guidance only and no representation is made by the NTA as to the accuracy, completeness, sufficiency or otherwise of this drawing and the position of the apparatus. The information contained herein does not purport to be comprehensive or final as the apparatus is subject to being altered and/or superceded. Recipients should not rely on this information. Any liabilities are hereby expressly disclaimed.

e. The information contained herein has been provided by the NTA but does not purport to be comprehensive or final. Recipients should not rely on the information. Neither the NTA nor any of its directors, officers, employees, agents, stakeholders or advisers make any representation or warranty as to, or accept any liability or responsibility in relation to, the adequacy, accuracy, reasonableness or completeness of the information provided as part of this document or any matter on which the information is based (including but not limited to loss or damage arising as a result of reliance by recipients on the information or any part of it). Any liabilities are hereby expressly disclaimed.



Rev	Date	Drn	Chk'd	App'd	Description
M01	FEB 2023	DS	EE	SMG	ISSUED FOR PHASE 4: PLANNING

Client: **NTA**  
Údarás Náisiúnta Iompair  
National Transport Authority

Engineering Designer: **CIROD**  
TYPSA

Date: FEB 2023 | Scale: 1:500 @ A1, 1:1000 @ A3 | Drawn: DS | Checked: EE | Approved: SMG

Programme Code: BCIDD | Originator Code: ROT | QMS Code:

Programme Title: <b>BUSCONNECTS DUBLIN CORE BUS CORRIDORS INFRASTRUCTURE WORKS</b>			
Drawing Title: KIMMAGE TO CITY CENTRE CORE BUS CORRIDOR SCHEME ESB ASSET ALTERATIONS			
Drawing File Name: BCIDD-ROT-UTL_UE-0011_XX_00-DR-CU-0011	Sheet Number: 11 of 14	Status: A	Rev: M01

DO NOT SCALE USE FIGURED DIMENSIONS ONLY

\\wddubp1u201919171719117-02\_WIP08 MODELS01 CAD01 DWG03 STG 3 - STATUTORY PROCESS (M)01 PLANNING11 KIMMAGEBCIDD-ROT-UTL\_UE-0011\_XX\_00-DR-CU-0001.dwg

**LEGEND:**

	EXISTING KERB LINE		PROPOSED KERB LINE
	ESB HV UG		ESB - HIGH VOLTAGE - PROPOSED UNDERGROUND DIVERSION
	ESB HV OH		ESB - HIGH VOLTAGE - PROPOSED OVERHEAD DIVERSION
	ESB MV UG		ESB - MEDIUM VOLTAGE - PROPOSED UNDERGROUND DIVERSION
	ESB MV OH		ESB - MEDIUM VOLTAGE - PROPOSED OVERHEAD DIVERSION
	ESB LV UG		ESB - LOW VOLTAGE - PROPOSED UNDERGROUND DIVERSION
	ESB LV OH		ESB - LOW VOLTAGE - PROPOSED OVERHEAD DIVERSION
	SITE BOUNDARY LINE		TEMPORARY LAND ACQUISITION
	EXISTING NETWORK TO BE DECOMMISSIONED		

**NOTES:**

1. UTILITY LOCATIONS ARE INDICATIVE ONLY AND BASED ON UTILITY PROVIDER RECORDS

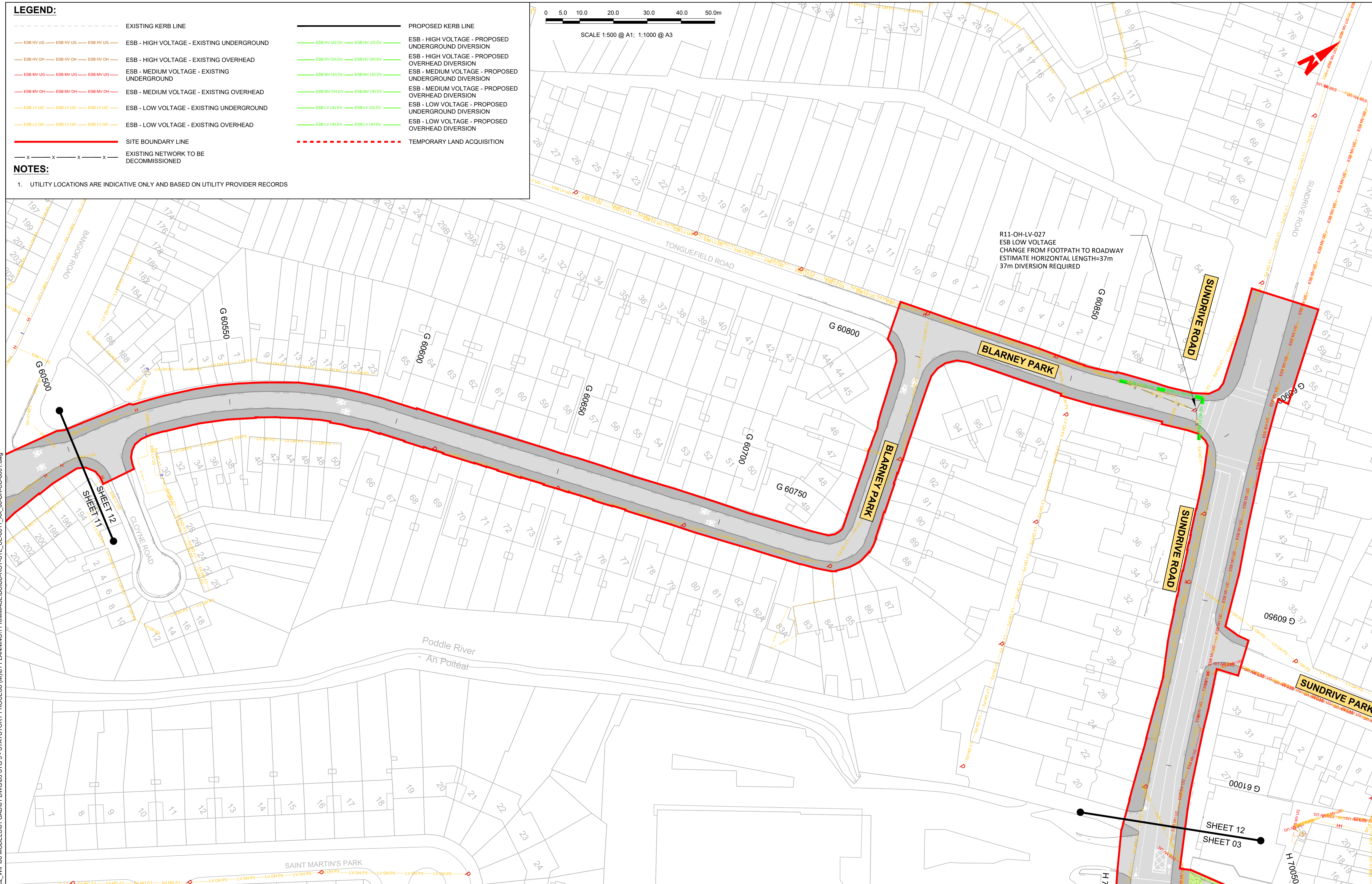
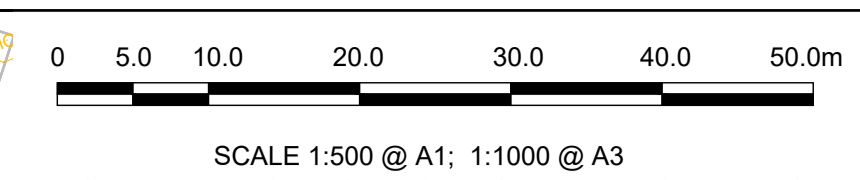

R11-OH-LV-027  
ESB LOW VOLTAGE  
CHANGE FROM FOOTPATH TO ROADWAY  
ESTIMATE HORIZONTAL LENGTH=37m  
37m DIVERSION REQUIRED

W:\000000\11\17-02\_WIP\08 MODELS\01 CAD\01 DWG\03 STG 3 - STATUTORY PROCESS (M)\01 PLANNING\11 KIMMAGE\BCIDD-ROT-UTL\_UE-0011\_XX\_00-DR-CU-0001.dwg

**Disclaimer**

a. © National Transport Authority (NTA) 2022. This drawing is confidential and the copyright in it is owned by NTA. This drawing must not be either loaned, copied or otherwise reproduced in whole or in part or used for any purpose without the prior permission of NTA.

b. This drawing is to be used for the design element identified in the titleblock. Other information shown is to be considered indicative only. The drawing is to be read in conjunction with all other relevant design drawings.

c. O.S. data used for plans are printed under © Ordnance Survey Ireland Government of Ireland. All rights reserved. Licence Number 2022/OSI\_NMA\_180 National Transport Authority. All elevations are in metres and relate to OSI Geoid Model (OSGM15) Mean Head. All Co-ordinates are in Irish Transverse Mercator Grid (ITM) as defined by OSI active local GPS station.

d. Information concerning the position of apparatus shown on this drawing is based on drawings supplied by the utility owners and/or the utility works contractor, whilst every care has been taken in the preparation of this drawing, positions should be taken as approximate and are intended for general guidance only and no representation is made by the NTA as to the accuracy, completeness, sufficiency or otherwise of this drawing and the position of the apparatus. The information contained herein does not purport to be comprehensive or final as the apparatus is subject to being altered and/or superceded. Recipients should not rely on this information. Any liabilities are hereby expressly disclaimed.

e. The information contained herein has been provided by the NTA but does not purport to be comprehensive or final. Recipients should not rely on the information. Neither the NTA nor any of its directors, officers, employees, agents, stakeholders or advisers make any representation or warranty as to, or accept any liability or responsibility in relation to, the adequacy, accuracy, reasonableness or completeness of the information provided as part of this document or any matter on which the information is based (including but not limited to loss or damage arising as a result of reliance by recipients on the information or any part of it). Any liabilities are hereby expressly disclaimed.



Rev	Date	Drn	Chk'd	App'd	Description
M01	FEB 2023	DS	EE	SMG	ISSUED FOR PHASE 4: PLANNING

Client <b>NTA</b> Udarás Náisiúnta Iompair National Transport Authority		Engineering Designer <b>CIROD</b> TYPSA		
Date FEB 2023	Scale 1:500 @ A1 1:1000 @ A3	Drawn DS	Checked EE	Approved SMG
Programme Code BCIDD	Originator Code ROT	QMS Code		

Programme Title <b>BUSCONNECTS DUBLIN</b> <b>CORE BUS CORRIDORS INFRASTRUCTURE WORKS</b>				
Drawing Title KIMMAGE TO CITY CENTRE CORE BUS CORRIDOR SCHEME ESB ASSET ALTERATIONS				
Drawing File Name BCIDD-ROT-UTL_UE-0011_XX_00-DR-CU-0012	Sheet Number 12 of 14	Status A	Rev M01	

DO NOT SCALE USE FIGURED DIMENSIONS ONLY



**LEGEND:**

	EXISTING KERB LINE		SITE BOUNDARY LINE
	ESB - HIGH VOLTAGE - EXISTING UNDERGROUND		ESB - HIGH VOLTAGE - PROPOSED UNDERGROUND DIVERSION
	ESB - HIGH VOLTAGE - EXISTING OVERHEAD		ESB - HIGH VOLTAGE - PROPOSED OVERHEAD DIVERSION
	ESB - MEDIUM VOLTAGE - EXISTING UNDERGROUND		ESB - MEDIUM VOLTAGE - PROPOSED UNDERGROUND DIVERSION
	ESB - MEDIUM VOLTAGE - EXISTING OVERHEAD		ESB - MEDIUM VOLTAGE - PROPOSED OVERHEAD DIVERSION
	ESB - LOW VOLTAGE - EXISTING UNDERGROUND		ESB - LOW VOLTAGE - PROPOSED UNDERGROUND DIVERSION
	ESB - LOW VOLTAGE - EXISTING OVERHEAD		ESB - LOW VOLTAGE - PROPOSED OVERHEAD DIVERSION
	TEMPORARY LAND ACQUISITION		
	EXISTING NETWORK TO BE DECOMMISSIONED		

**NOTES:**

- UTILITY LOCATIONS ARE INDICATIVE ONLY AND BASED ON UTILITY PROVIDER RECORDS



SCALE 1:500 @ A1; 1:1000 @ A3

**Disclaimer**

a. © National Transport Authority (NTA) 2022. This drawing is confidential and the copyright in it is owned by NTA. This drawing must not be either loaned, copied or otherwise reproduced in whole or in part or used for any purpose without the prior permission of NTA.

b. This drawing is to be used for the design element identified in the titleblock. Other information shown is to be considered indicative only. The drawing is to be read in conjunction with all other relevant design drawings.

c. O.S. data used for plans are printed under © Ordnance Survey Ireland Government of Ireland. All rights reserved. Licence Number 2022/OSI\_NMA\_180 National Transport Authority. All elevations are in metres and relate to OSI Geoid Model (OSGM15) Mean Head. All Co-ordinates are in Irish Transverse Mercator Grid (ITM) as defined by OSI active local GPS station.

d. Information concerning the position of apparatus shown on this drawing is based on drawings supplied by the utility owners and/or the utility works contractor, whilst every care has been taken as to, or accept any liability or responsibility in relation to, the adequacy, accuracy, reasonableness or completeness of the information provided as part of this document or any matter on which the information is based (including but not limited to loss or damage arising as a result of reliance by recipients on the information or any part of it). Any liabilities are hereby expressly disclaimed.



Rev	Date	Drm	Chk'd	App'd	Description
M01	FEB 2023	DS	EE	SMG	ISSUED FOR PHASE 4: PLANNING

Client

Udárás Náisiúnta Iompair  
National Transport Authority

Engineering Designer

Drawn DS  
Checked EE  
Approved SMG

Programme Title

**BUSCONNECTS DUBLIN**  
**CORE BUS CORRIDORS INFRASTRUCTURE WORKS**

Drawing Title

KIMMAGE TO CITY CENTRE CORE BUS CORRIDOR SCHEME  
ESB ASSET ALTERATIONS

Drawing File Name: BCIDD-ROT-UTL\_UE-0011\_XX\_00-DR-CU-0013

Sheet Number: 13 of 14

Status: A

Rev: M01

DO NOT SCALE USE FIGURED DIMENSIONS ONLY

\\nodubp1\U201919\17119117-02\_WIP\08 MODELS\01 CAD\01 DWG\03 STG 3 - STATUTORY PROCESS (M)\01 PLANNING\11 KIMMAGE\BCIDD-ROT-UTL\_UE-0011\_XX\_00-DR-CU-0001.dwg



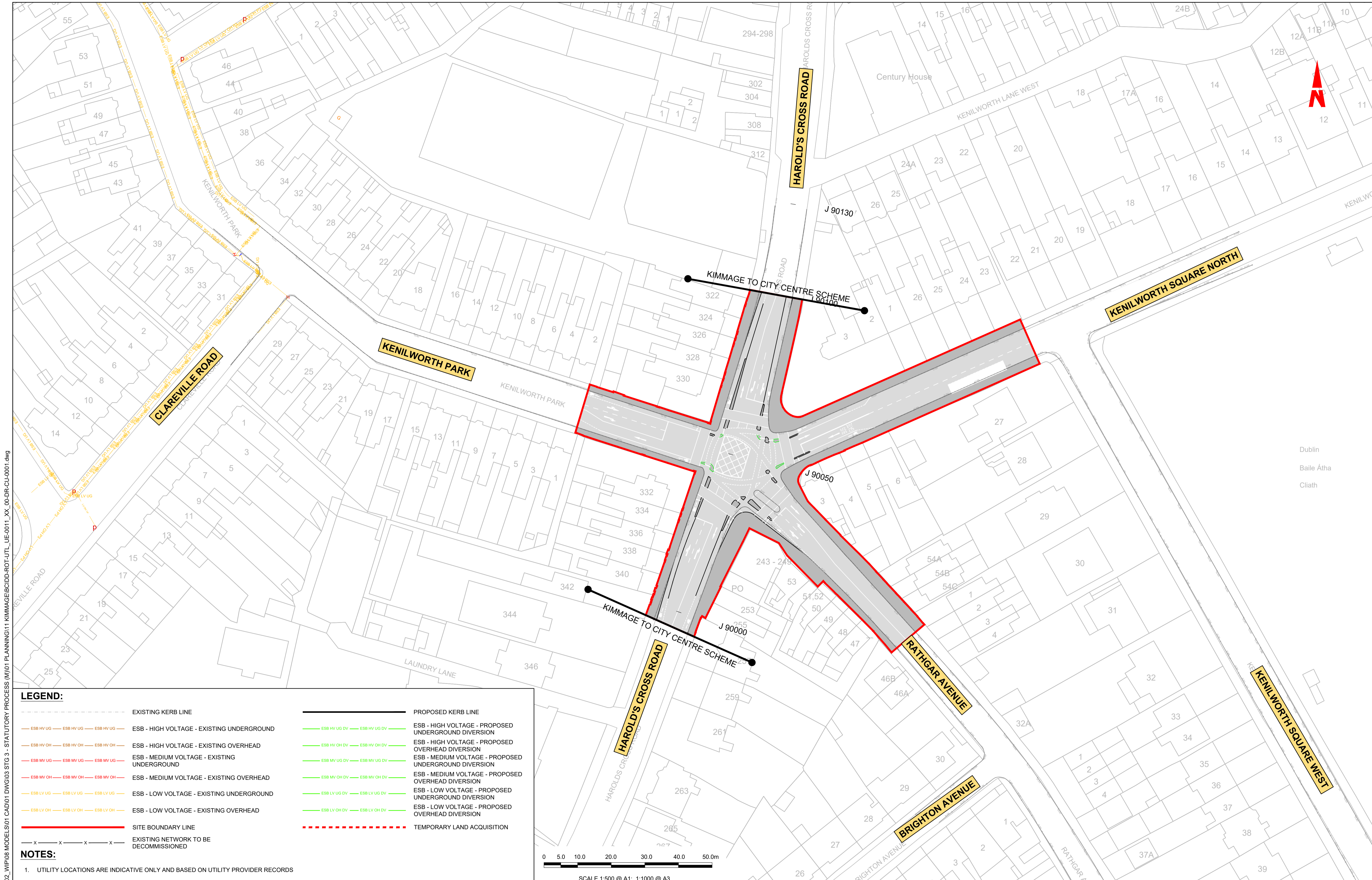

**LEGEND:**

--- EXISTING KERB LINE	--- PROPOSED KERB LINE
--- ESB HV UG --- ESB HV UG --- ESB HV UG --- ESB - HIGH VOLTAGE - EXISTING UNDERGROUND	--- ESB HV UG DV --- ESB HV UG DV --- ESB - HIGH VOLTAGE - PROPOSED UNDERGROUND DIVERSION
--- ESB HV OH --- ESB HV OH --- ESB HV OH --- ESB - HIGH VOLTAGE - EXISTING OVERHEAD	--- ESB HV OH DV --- ESB HV OH DV --- ESB - HIGH VOLTAGE - PROPOSED OVERHEAD DIVERSION
--- ESB MV UG --- ESB MV UG --- ESB MV UG --- ESB - MEDIUM VOLTAGE - EXISTING UNDERGROUND	--- ESB MV UG DV --- ESB MV UG DV --- ESB - MEDIUM VOLTAGE - PROPOSED UNDERGROUND DIVERSION
--- ESB MV OH --- ESB MV OH --- ESB MV OH --- ESB - MEDIUM VOLTAGE - EXISTING OVERHEAD	--- ESB MV OH DV --- ESB MV OH DV --- ESB - MEDIUM VOLTAGE - PROPOSED OVERHEAD DIVERSION
--- ESB LV UG --- ESB LV UG --- ESB LV UG --- ESB - LOW VOLTAGE - EXISTING UNDERGROUND	--- ESB LV UG DV --- ESB LV UG DV --- ESB - LOW VOLTAGE - PROPOSED UNDERGROUND DIVERSION
--- ESB LV OH --- ESB LV OH --- ESB LV OH --- ESB - LOW VOLTAGE - EXISTING OVERHEAD	--- ESB LV OH DV --- ESB LV OH DV --- ESB - LOW VOLTAGE - PROPOSED OVERHEAD DIVERSION
--- SITE BOUNDARY LINE	--- TEMPORARY LAND ACQUISITION
--- x --- x --- x --- x --- EXISTING NETWORK TO BE DECOMMISSIONED	

**NOTES:**

1. UTILITY LOCATIONS ARE INDICATIVE ONLY AND BASED ON UTILITY PROVIDER RECORDS

\\produbp1\j2019\1917\17-02\_WIP08 MODELS\01 CAD\01 DWG\03 STG 3 - STATUTORY PROCESS (M)\01 PLANNING\11 KIMMAGE\BCIDD-ROT-UTL\_UE-0011\_XX\_00-DR-CU-0001.dwg

**Disclaimer**

a. © National Transport Authority (NTA) 2022. This drawing is confidential and the copyright in it is owned by NTA. This drawing must not be either loaned, copied or otherwise reproduced in whole or in part or used for any purpose without the prior permission of NTA.

b. This drawing is to be used for the design element identified in the titleblock. Other information shown is to be considered indicative only. The drawing is to be read in conjunction with all other relevant design drawings.

c. O.S. data used for plans are printed under © Ordnance Survey Ireland Government of Ireland. All rights reserved. Licence Number 2022/OSI\_NMA\_180 National Transport Authority. All elevations are in metres and relate to OSI Geoid Model (OSGM15) Mean Head. All Co-ordinates are in Irish Transverse Mercator Grid (ITM) as defined by OSI active local GPS station.

d. Information concerning the position of apparatus shown on this drawing is based on drawings supplied by the utility owners and/or the utility works contractor, whilst every care has been taken in the preparation of this drawing, positions should be taken as approximate and are intended for general guidance only and no representation is made by the NTA as to the accuracy, completeness, sufficiency or otherwise of this drawing and the position of the apparatus. The information contained herein does not purport to be comprehensive or final as the apparatus is subject to being altered and/or superceded. Recipients should not rely on this information. Any liabilities are hereby expressly disclaimed.

e. The information contained herein has been provided by the NTA but does not purport to be comprehensive or final. Recipients should not rely on the information. Neither the NTA nor any of its directors, officers, employees, agents, stakeholders or advisers make any representation or warranty as to, or accept any liability or responsibility in relation to, the adequacy, accuracy, reasonableness or completeness of the information provided as part of this document or any matter on which the information is based (including but not limited to loss or damage arising as a result of reliance by recipients on the information or any part of it). Any liabilities are hereby expressly disclaimed.

Rev	Date	Drn	Chk'd	App'd	Description
M01	FEB 2023	DS	EE	SMG	ISSUED FOR PHASE 4: PLANNING

<p>Udarás Náisiúnta Iompair National Transport Authority</p>		<p>Engineering Designer</p>		
Date	Scale	Drawn	Checked	Approved
FEB 2023	1:500 @ A1 1:1000 @ A3	DS	EE	SMG
Programme Code	Originator Code	QMS Code		
BCIDD	ROT			

<p>Programme Title</p> <p><b>BUSCONNECTS DUBLIN</b></p> <p><b>CORE BUS CORRIDORS INFRASTRUCTURE WORKS</b></p>			
<p>Drawing Title</p> <p>KIMMAGE TO CITY CENTRE CORE BUS CORRIDOR SCHEME</p> <p>ESB ASSET ALTERATIONS</p>			
Drawing File Name	Sheet Number	Status	Rev
BCIDD-ROT-UTL_UE-0011_XX_00-DR-CU-0014	14 of 14	A	M01

DO NOT SCALE USE FIGURED DIMENSIONS ONLY